

PLASTIC UTILITY CART

Model 24413

- 8 cu. ft. heaped capacity.
- 4.00 X 6 pneumatic tires.
- Hitch pin included.

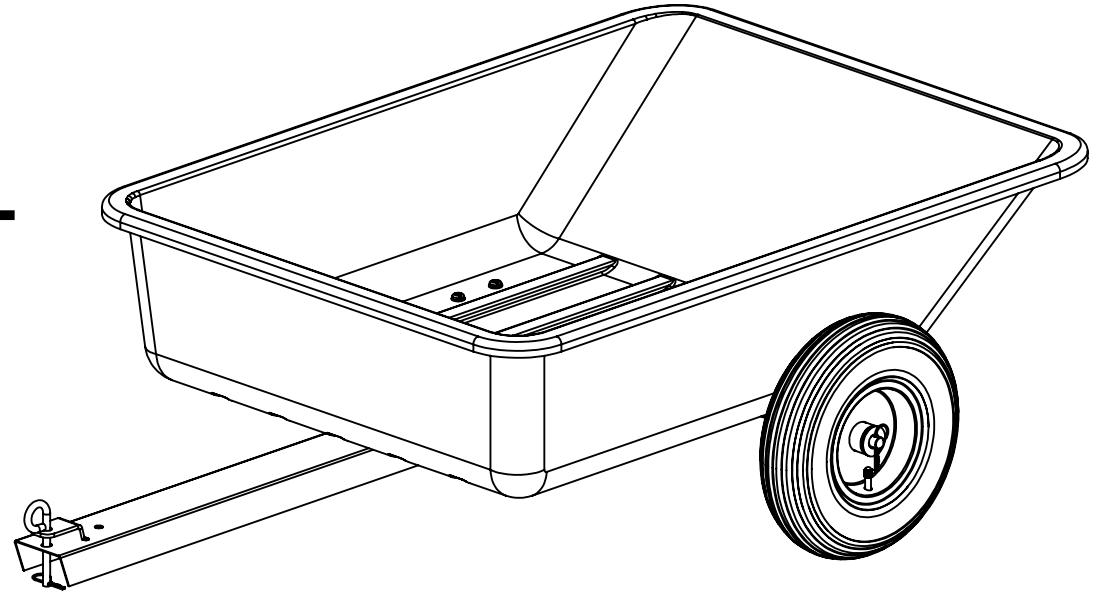

If you read and follow these instructions, this product can be assembled in 20 minutes or less. If you don't read these instructions, assembly may take over an hour!



TO MINIMIZE ASSEMBLY TIME:

- **DO NOT tighten fasteners until instructed to do so.**
- **Assemble unit on cardboard box to avoid scratches or damage to parts.**
- **For best results, two people are required for assembly.**

- If there are any missing parts, or if you have any questions on assembly, operation, maintenance or safety, please call:
1-800-652-2321
- All fasteners are readily available for purchase at your nearest local hardware store.

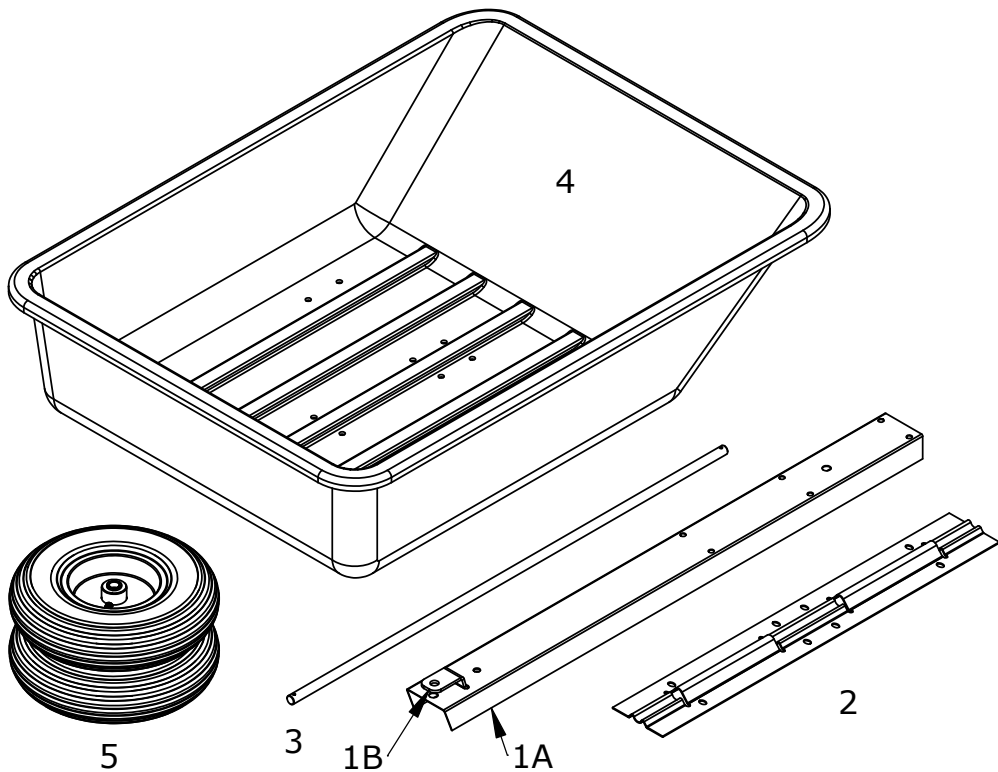

CARTON CONTENTS

REF.NO.	AMT	DESCRIPTION	REF.NO.	AMT	DESCRIPTION
1A	1	HITCH	4	1	PLASTIC CART BODY
1B	1	HITCH BRACKET	5	2	WHEEL
2	1	AXLE HOLDER	INST	1	USER GUIDE
3	1	AXLE	BB	1	HARDWARE BAG

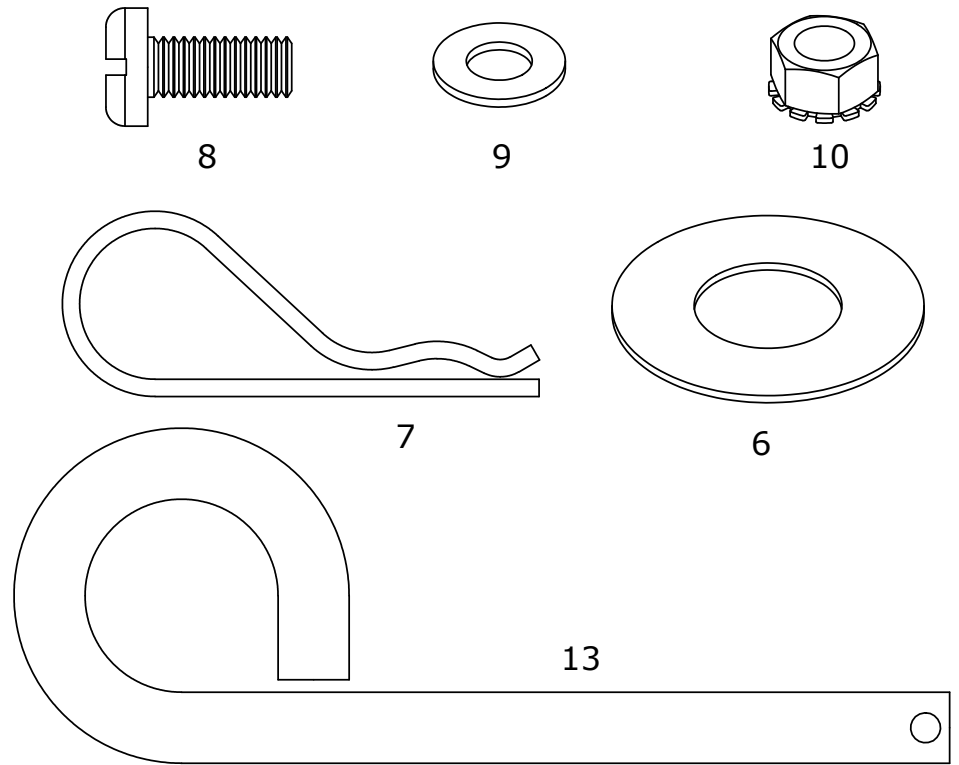

HARDWARE BAG

REF.NO.	AMT	DESCRIPTION	REF.NO.	AMT	DESCRIPTION
6	4	AXLE WASHER	9	12	5/16" FLAT WASHER
7	3	HAIR PIN COTTER	10	12	NUT 5/16" KEPS
8	12	BOLT 5/16" x 3/4" PAN	13	1	HITCH PIN

SAFETY INSTRUCTIONS

- When operating on slopes, use lowest ground speed and limit load.
- Do not carry passengers in cart.
- Do not use cart on public roads.
- Operate up and down slopes, never across the face of slopes.
- Avoid sudden turns and maneuvers.

MAINTENANCE & STORAGE

- Periodically check all nuts and bolts for tightness.
- Check tire pressure regularly.
- Grease wheels at axle for longer life.
- Keep cart clean and dry to prevent rust and corrosion.
- Store inside a clean, dry area when not in use.

TOOLS SUGGESTED FOR ASSEMBLY

- Large blade screwdriver.
- 1/2" wrench and/or socket.
- Cordless drill.

A Adding Axle Holder & Axle.

Step 1. Add axle holder (2) to body (4) with six 5/16" x 3/4" pan head bolts (8), flat washer (9) and keps nuts (10).

Step 2. Slide axle (3) into axle holder (4) as shown, and center.

NOTE: DO NOT INSERT BOLTS IN THE TWO HOLES DESIGNATED "X" AT THIS TIME, THEY WILL BE ADDED IN NEXT STEP.

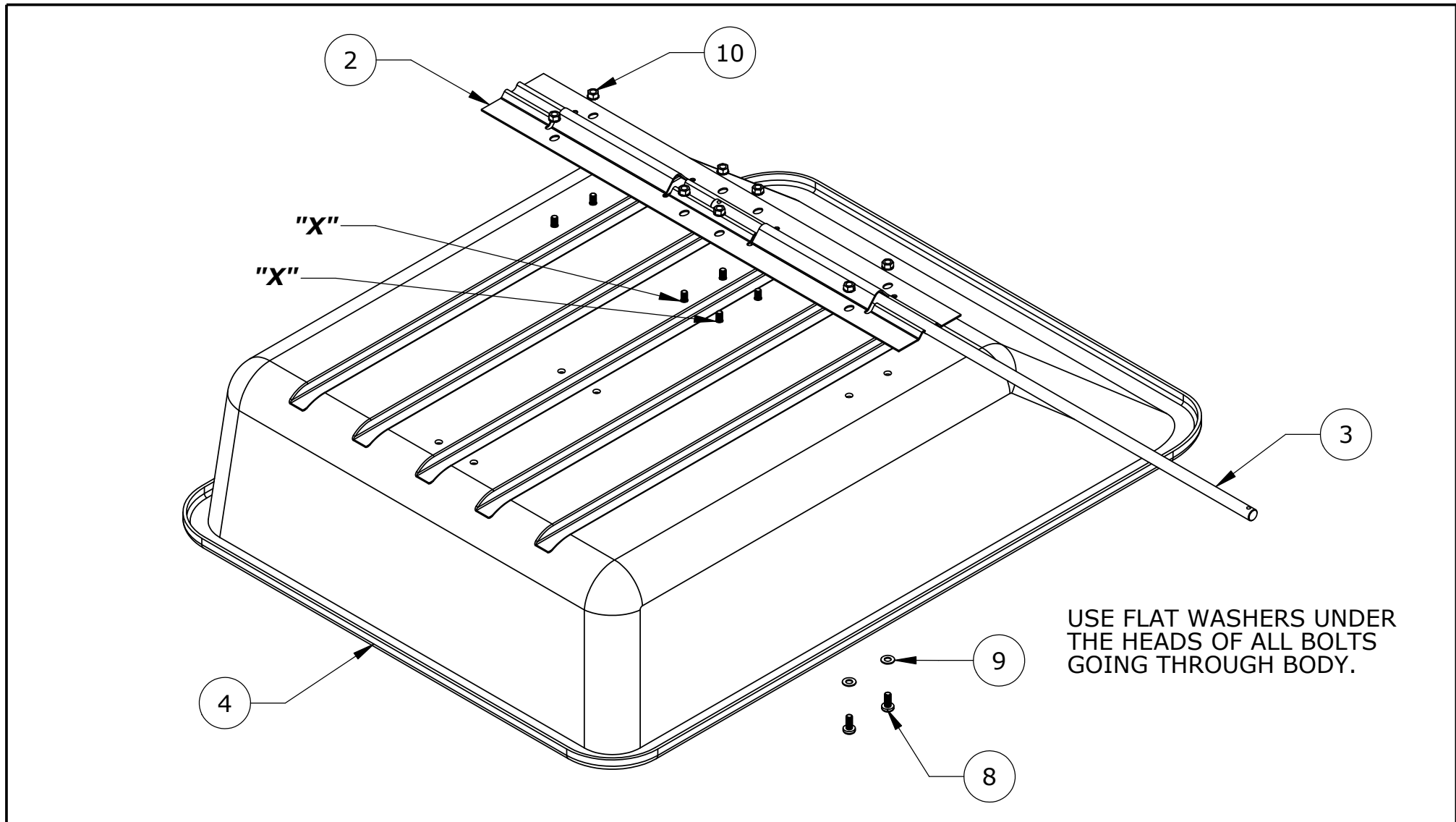

B Adding the Hitch & Wheels.

Step 3. Add hitch (1) to body (4) as shown with six 5/16" x 3/4" pan head bolts (8), flat washers (9) and keps nuts (10).

Step 4. Slide axle washer (6), wheel (5), with valve stem facing out, axle washer (6) and lock in place with hair pin (7). Repeat step 4 for other side.

Step 5. **Make sure all bolts and nuts are tight at this time.** Turn cart upright on wheels.

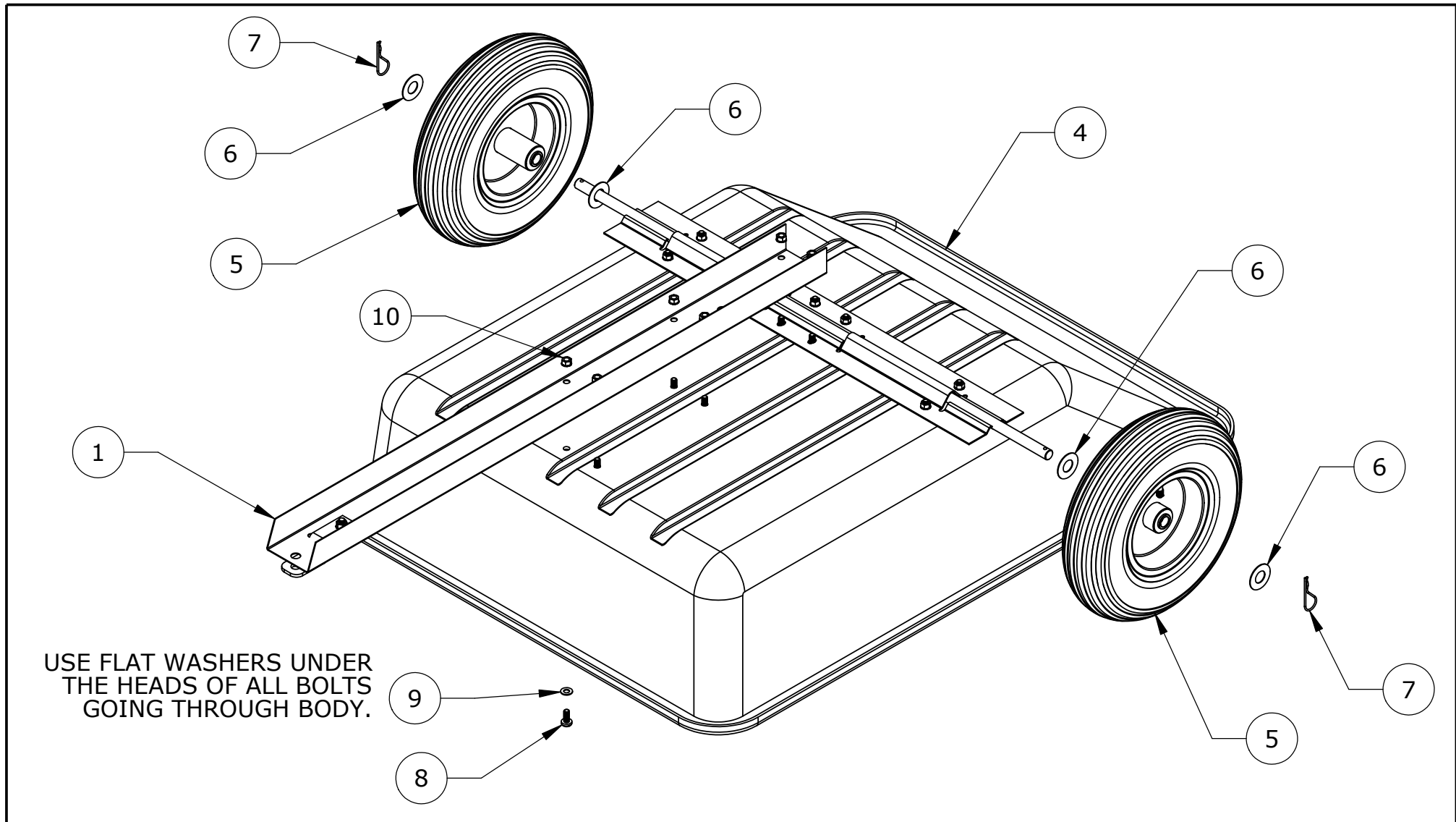

24413 Repair Parts List.

OHIO

PLASTIC UTILITY CART

Model 24413

15 1/2" x 24" x 16"

150 lbs. capacity

150 lbs. capacity

150 lbs. capacity

150 lbs. capacity

150 lbs. capacity

150 lbs. capacity

150 lbs. capacity

150 lbs. capacity

150 lbs. capacity

150 lbs. capacity

150 lbs. capacity

150 lbs. capacity

150 lbs. capacity

150 lbs. capacity

150 lbs. capacity

150 lbs. capacity

150 lbs. capacity

150 lbs. capacity

150 lbs. capacity

150 lbs. capacity

150 lbs. capacity

150 lbs. capacity

150 lbs. capacity

150 lbs. capacity

150 lbs. capacity

150 lbs. capacity

150 lbs. capacity

150 lbs. capacity

150 lbs. capacity

150 lbs. capacity

150 lbs. capacity

150 lbs. capacity

150 lbs. capacity

150 lbs. capacity

150 lbs. capacity

150 lbs. capacity

150 lbs. capacity

150 lbs. capacity

150 lbs. capacity

150 lbs. capacity

150 lbs. capacity

150 lbs. capacity

150 lbs. capacity

150 lbs. capacity

150 lbs. capacity

150 lbs. capacity

150 lbs. capacity

150 lbs. capacity

150 lbs. capacity

150 lbs. capacity

150 lbs. capacity

150 lbs. capacity

150 lbs. capacity

150 lbs. capacity

150 lbs. capacity

150 lbs. capacity

150 lbs. capacity

150 lbs. capacity

150 lbs. capacity

150 lbs. capacity

150 lbs. capacity

150 lbs. capacity

150 lbs. capacity

150 lbs. capacity

150 lbs. capacity

150 lbs. capacity

150 lbs. capacity

150 lbs. capacity

150 lbs. capacity

150 lbs. capacity

150 lbs. capacity

150 lbs. capacity

150 lbs. capacity

150 lbs. capacity

150 lbs. capacity

150 lbs. capacity

150 lbs. capacity

150 lbs. capacity

150 lbs. capacity

150 lbs. capacity

150 lbs. capacity

150 lbs. capacity

150 lbs. capacity

150 lbs. capacity



INST

BB

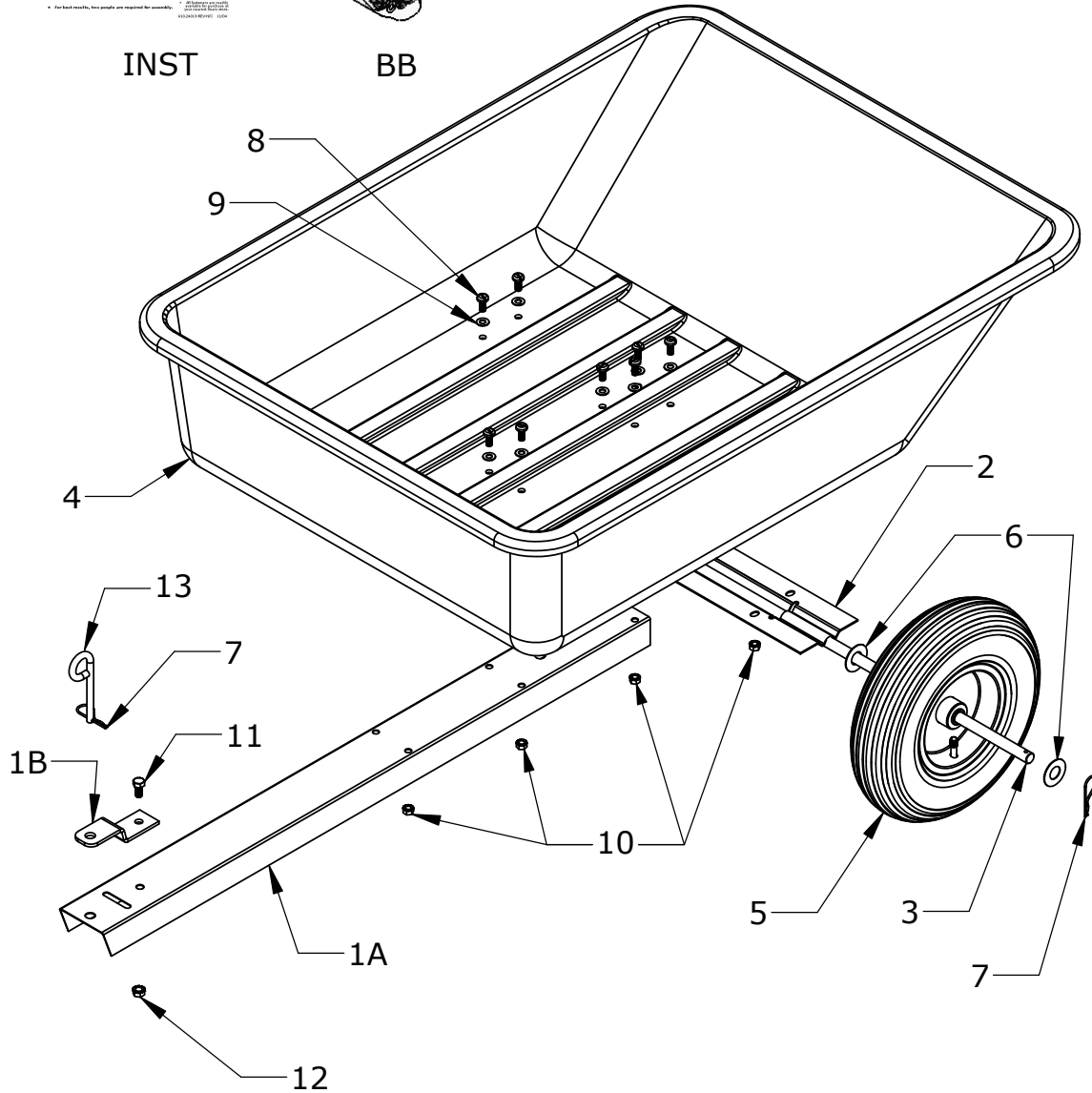

REPAIR PARTS LIST

REF.NO.	PART NO.	AMT.	DESCRIPTION
1A	24413-01	1	24413 HITCH
1B	55-16	1	24355 HITCH BRACKET
2	24413-02	1	24413 AXLE HOLDER
3	24413-03	1	24413 AXLE
4	24413-04	1	24413 CART BODY
5	24413-05	2	24413 WHEEL
6*	STDWF750SAE	4	WASHER, FLAT 3/4" SAE
7*	STD624007	3	PIN, HAIRPIN COTTER
8*	STDBP3130750	12	BOLT, PAN 5/16"-18 X 3/4"
9*	STDWF313SAE	12	WASHER, FLAT 5/16" SAE
10*	STDNK313	12	NUT, KEPS 5/16"-18
11*	STDBH3750750	1	BOLT, HEX 3/8"-16 X 3/4"
12*	STDNK375	1	NUT, KEPS 3/8"-16
13	55-30	1	24355 HP-3 HITCH PIN
INST	24413-INST	1	24413 USER GUIDE
BB	24413-BB	1	24413 HARDWARE BAG

* Denotes standard hardware items that can be bought locally.

LIMITED ONE-YEAR WARRANTY

If this product fails due to a defect in material or workmanship within one year from the date of purchase, we will at our option repair or replace it free of charge. This warranty excludes tires and wheels, which are expendable and become worn during normal use.

This warranty does not cover:

- Repairs necessary because of operator abuse or negligence.
- Equipment used for commercial or rental purposes.

To arrange for product repair call 1-800-652-2321, or return this product to place of purchase for replacement.

This warranty gives you specific legal rights, and you may also have other rights which may vary from state to state. This warranty applies only while this product is in use in the United States.

PRODUCT RECORD

In the space below record the model number and purchase date of your cart.

Model Number _____.

Purchase Date _____.

Keep this booklet and your receipt in a safe place for future reference.

ORDERING INFORMATION

After the one year warranty period all parts may be ordered by calling 1-800-652-2321.

When ordering repair parts, always give the following information:

- Product - Plastic Utility Hauling Cart.
- Model Number - 24413.
- Part Number - * _____.
- Part Description - * _____.

*Found on the repair part list. Reference page 5.