



AF-1836SR

18 X 36 LAWN ROLLER



READ AND FOLLOW ALL SAFETY RULES AND OPERATING
INSTRUCTIONS BEFORE USING THIS EQUIPMENT

Safety Rules



This is the safety alert symbol. It is used to alert you to potential personal injury hazards. Obey all safety messages that follow this symbol to avoid possible injury or death.

Read and understand all safety rules and operating instructions before using this tractor attachment.

Follow all safety rules and operating instructions provided by your tractor's manufacturer when using attachment.

Never allow children or untrained persons to operate vehicle or attachment.

Do not carry passenger on vehicle or attachment.

Avoid sudden turns or maneuvers.

Do not remove warning decals from product.

Do not tow attachment on public roadways.

Check product for worn, loose or damaged parts before each use. If any damage is present, repair the product before using.

Check product for loose or missing fasteners before each use. Tighten or replace fasteners as needed before using.

Carton Contents

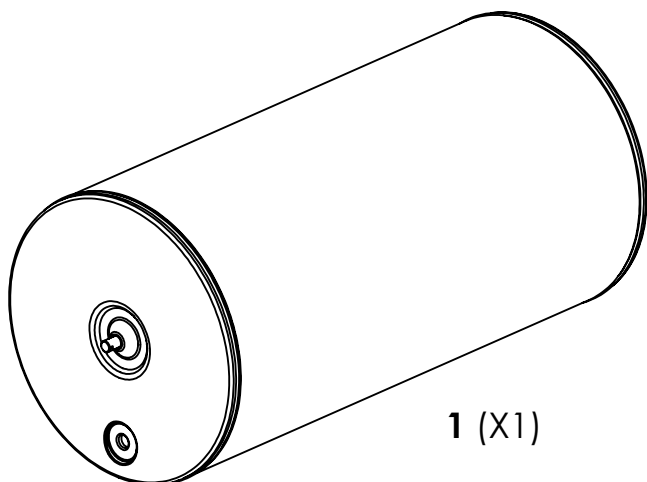

1 (X1)

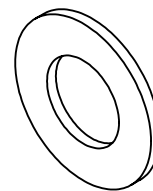

4 (X2)



5 (X2)

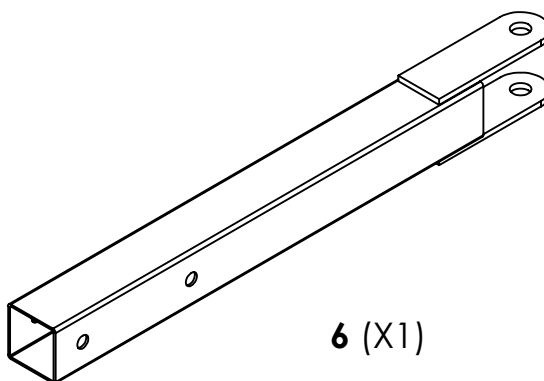

6 (X1)

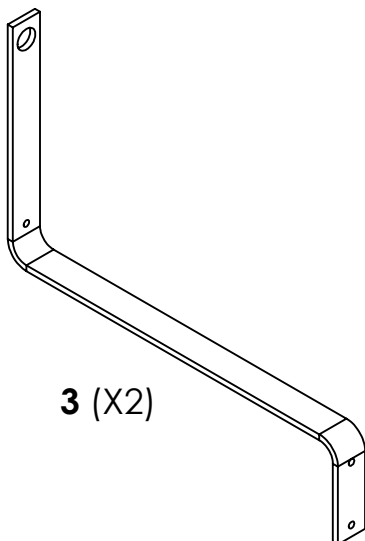

3 (X2)

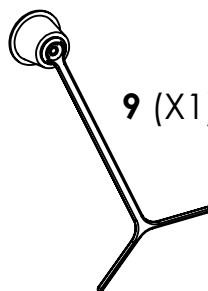

9 (X1)

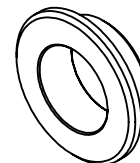

2 (X2)

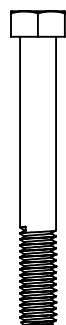

7 (X2)

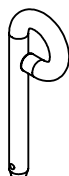

11 (X1)



12 (X1)



8 (X2)

TOOLS REQUIRED FOR ASSEMBLY

- 9/16" Wrench or Socket
- Pliers

Assembly Instructions

- 1** Slide side bars over axle with the flanges of the bearing towards the inside of the roller head, add washer and lock in place by inserting and spreading ends of the cotter pins.

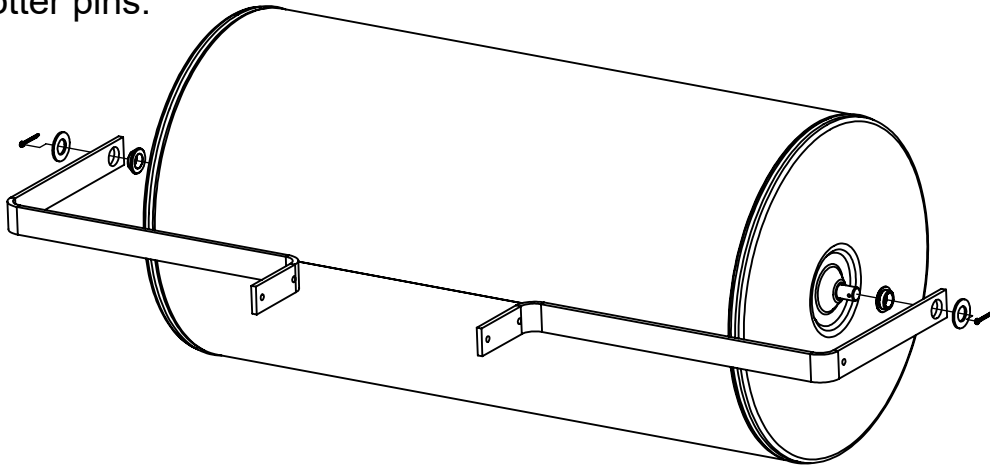

- 2** Add roller hitch weldment to side bars using 3/8" bolts and 3/8" nuts.

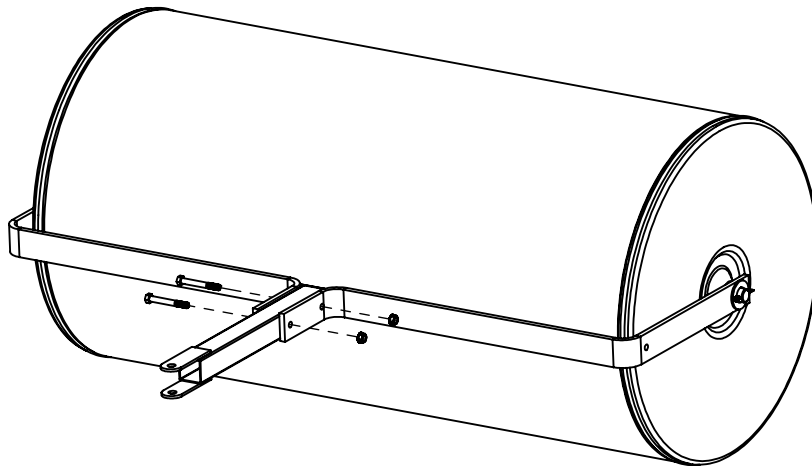

- 3** Install hitch pin and hairpin as shown.

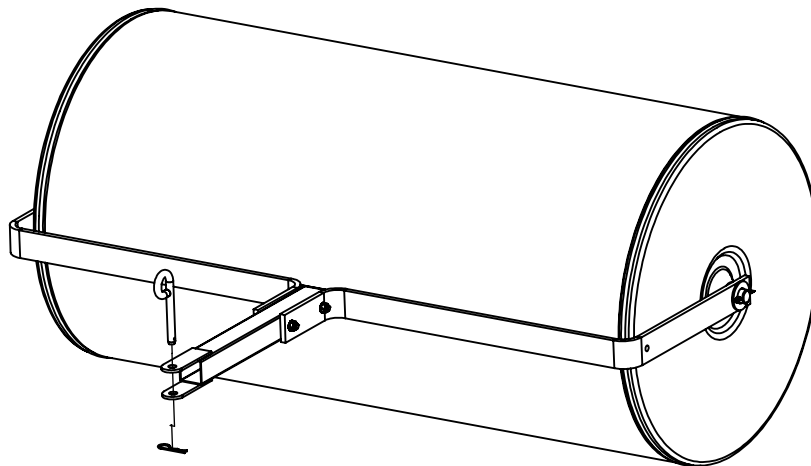

Operating Instructions

Before Using Lawn Roller:

Read all Safety Rules found on page 1.

Though most rollers are filled with water, we recommend adding Ethylene Glycol Anti-Freeze with the water. This will protect the tank from damage during cold weather. It is also recommended that the anti-freeze used, contain a rust inhibitor to protect the inside of the tank against rust. If the roller is filled with water only, it must be drained whenever the temperature drops below 32 degrees F. (0 degrees C). The roller weighs approximately 400 pounds when filled. Safe disposal of the antifreeze is recommended. Please follow the Anti-Freeze manufacturers warnings and disposal methods.

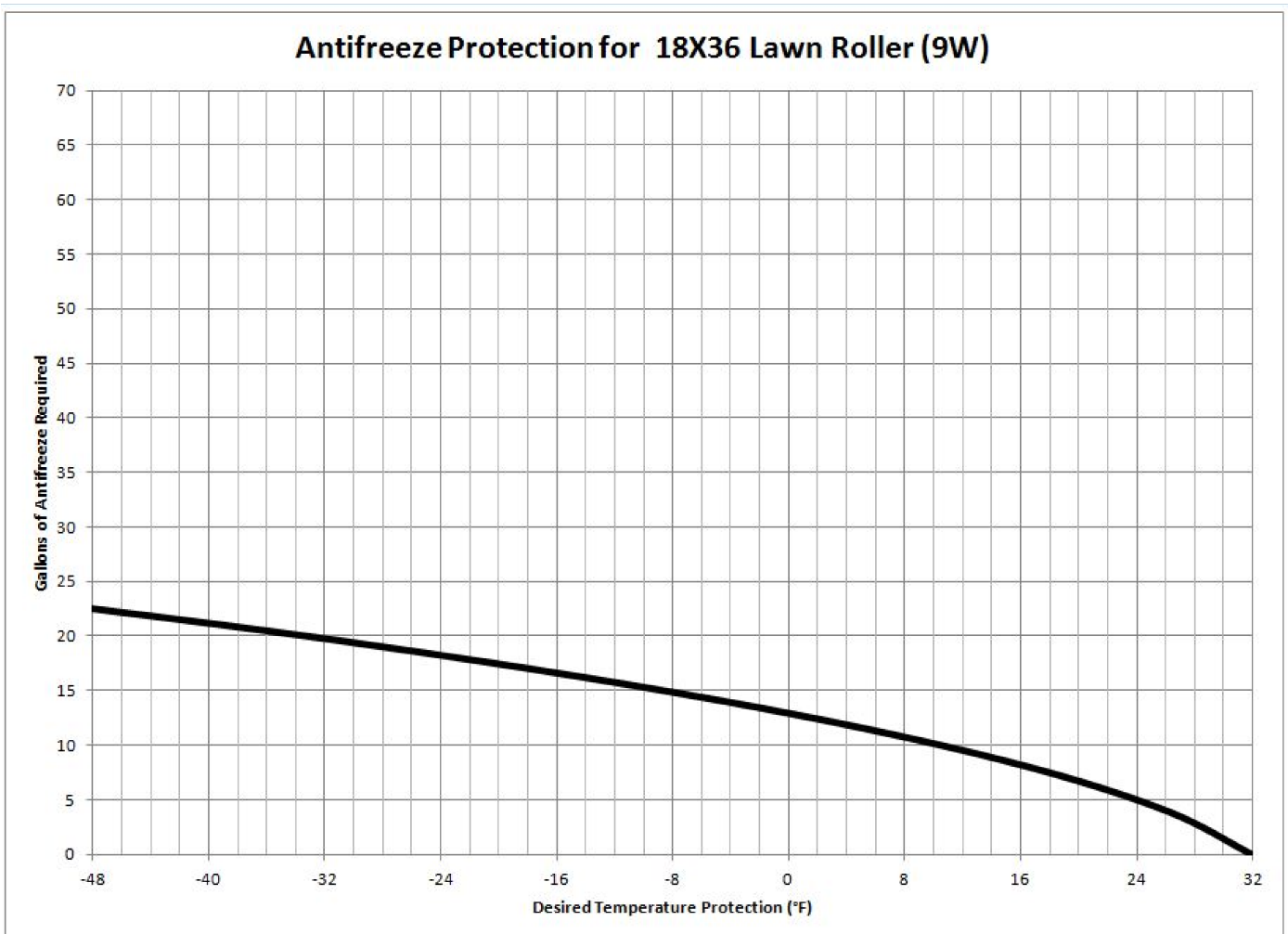

Warranty

If this product fails due to a defect in material or workmanship within TWO YEARS from the date of purchase, we will at our option repair or replace it free of charge.

This warranty does not cover:

- Repairs necessary because of operator abuse or negligence
- Equipment used for commercial or rental purposes.
- Paint that is worn or faded due to normal use or exposure.

To arrange for product repair call 1-800-652-2321, or return this product to place of purchase for replacement.

This warranty gives you specific legal rights, and you may also have other rights which may vary from state to state. This Warranty applies only while this product is in use in the United States.

In the space below record the purchase date of your Lawn Roller.

Model Number: **AF-1836SR** _____

Purchase Date: _____

Keep this Owner's Manual and your receipt in a safe place for future reference.

After the two year warranty period all replacement parts may be ordered by calling **1-800-652-2321**.

When ordering replacement parts, always give the following information:

- Product: **18X36 LAWN ROLLER** _____
- Model Number: **1836SR** _____
- Part Number: _____
- Part Description: _____

Repair Parts

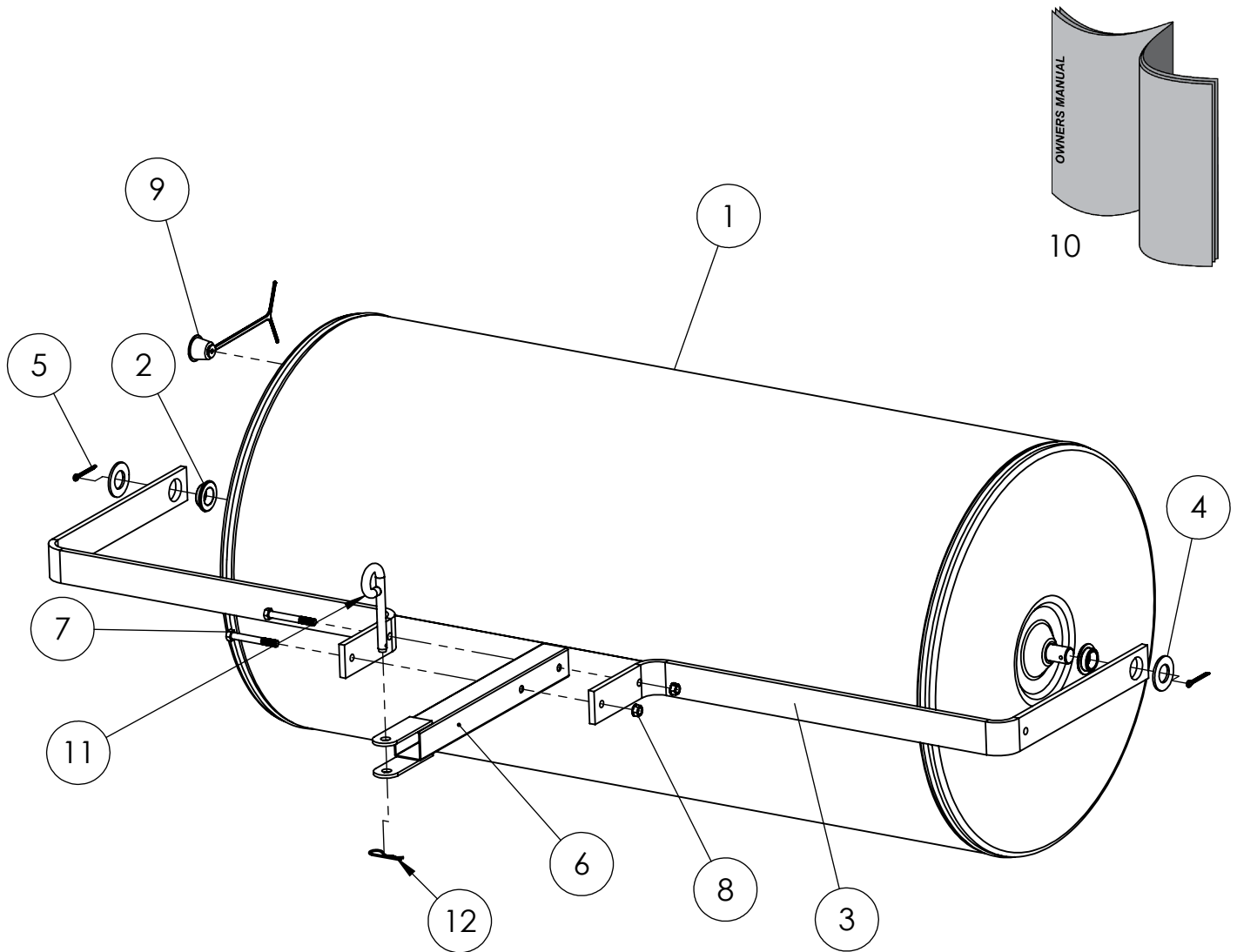

ITEM	PART NO	DESCRIPTION	QTY
1	504002	ROLLER BODY	1
2	304281	FLANGED BEARING	2
3	6004025	SIDE BAR	2
4	300076	1" AXLE WASHER	2
5	300087	COTTER PIN	2
6	6003900	ROLLER HITCH WELDMENT	1
7	300055	HEX BOLT, 3/8"-16 x 3"	2
8	300063	NUT 3/8"-16 KEPS	2
9	50401	PLUG ASSEMBLY	1
10	304049	OWNER'S MANUAL	1
11	6000533	PIN, HITCH	1
12	300084	HAIRPIN COTTER, 0.093" X 2-5/16"	1