

PROFESSIONAL GRADE



RT3HK Tandem Hitch Kit



**READ AND FOLLOW ALL SAFETY RULES AND OPERATING
INSTRUCTIONS BEFORE USING THIS EQUIPMENT**

Safety Rules



This is the safety alert symbol. It is used to alert you to potential personal injury hazards. Obey all safety messages that follow this symbol to avoid possible injury or death.

Read and understand all safety rules and operating instructions before using this tractor attachment.

Follow all safety rules and operating instructions provided by your tractor's manufacturer when using attachment.

Follow all safety rules and operating instructions provided by your sweeper's manufacturer when using attachment.

Never allow children or untrained persons to operate tractor or attachment.

Reduce tractor speed to slowest setting when towing or operating on slopes.

Operate up and down slopes, never across the face of slopes.

Do not carry passengers on tractor or attachment.

Avoid sudden turns or maneuvers.

Use caution when backing up to prevent damaging attachment.

Do not tow attachment on public roadways.

Do not remove warning decals from product.

Check product for worn, loose, or damaged parts before each use. If any damage is present, repair the product before using.

Check product for loose or missing fasteners before each use. Tighten or replace fasteners as needed before using.

Do not fasten rope to any part of your body or clothing.

Do not hold rope while tractor and Lawn Sweeper are in motion.

Do not use Lawn Sweeper near fire or smoldering debris.

Always empty hopper before storing to avoid spontaneous combustion of contents.

Do not exceed tractor speed of 6 miles per hour when towing or operating Lawn Sweeper.

Carton Contents

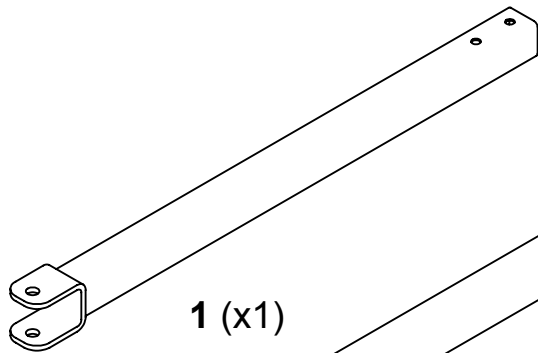

1 (x1)

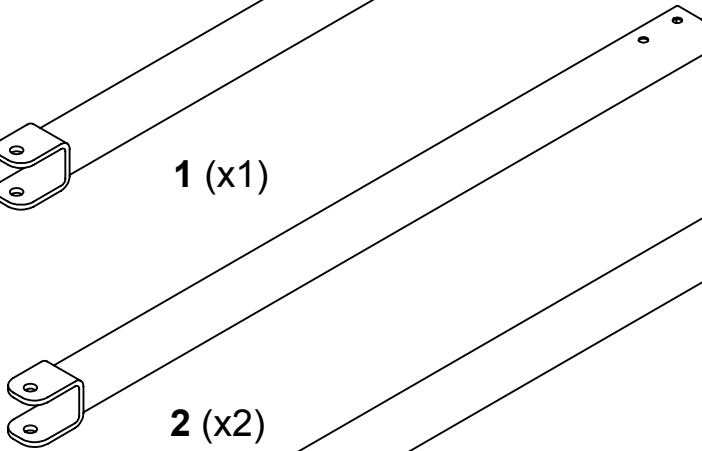

2 (x2)

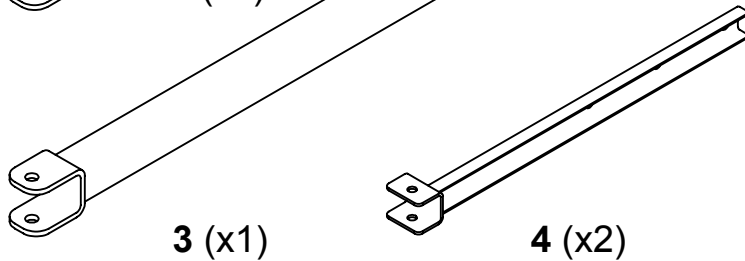

3 (x1)

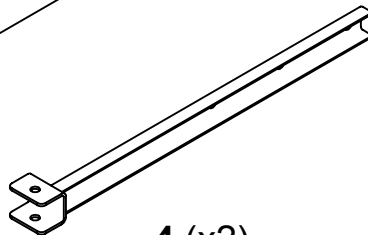

4 (x2)

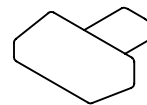

12 (x3)



13 (x1)

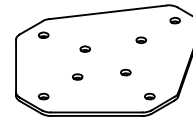

5 (x2)

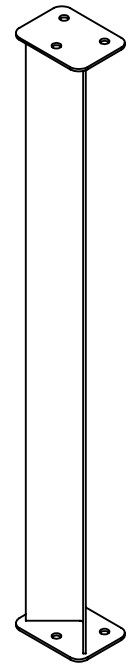

6 (x1)

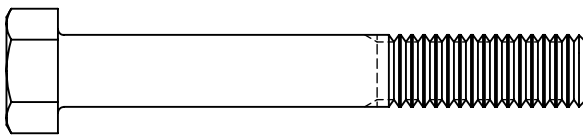

7 (x8)

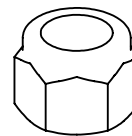

8 (x10)

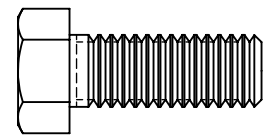

11 (x2)

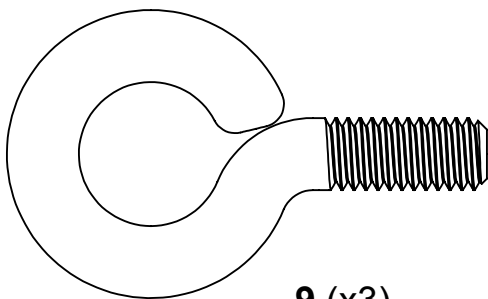

9 (x3)

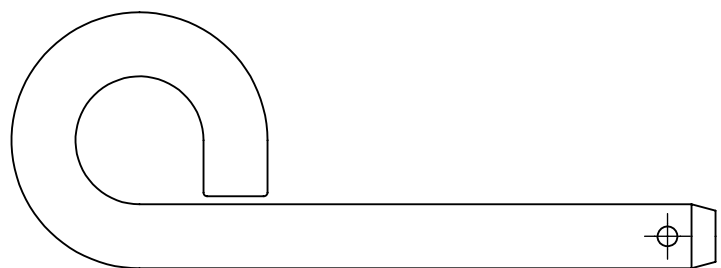

15 (x1)

TOOLS REQUIRED FOR ASSEMBLY:

- 9/16" WRENCH OR SOCKET
- ADJUSTABLE WRENCH

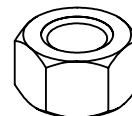

10 (x6)

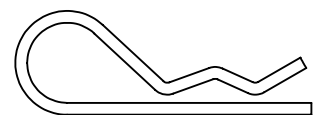

16 (x1)

Assembly Instructions

1

Carefully read all assembly instructions before beginning assembly.

NOTE: tube locations on plates and welded column direction.

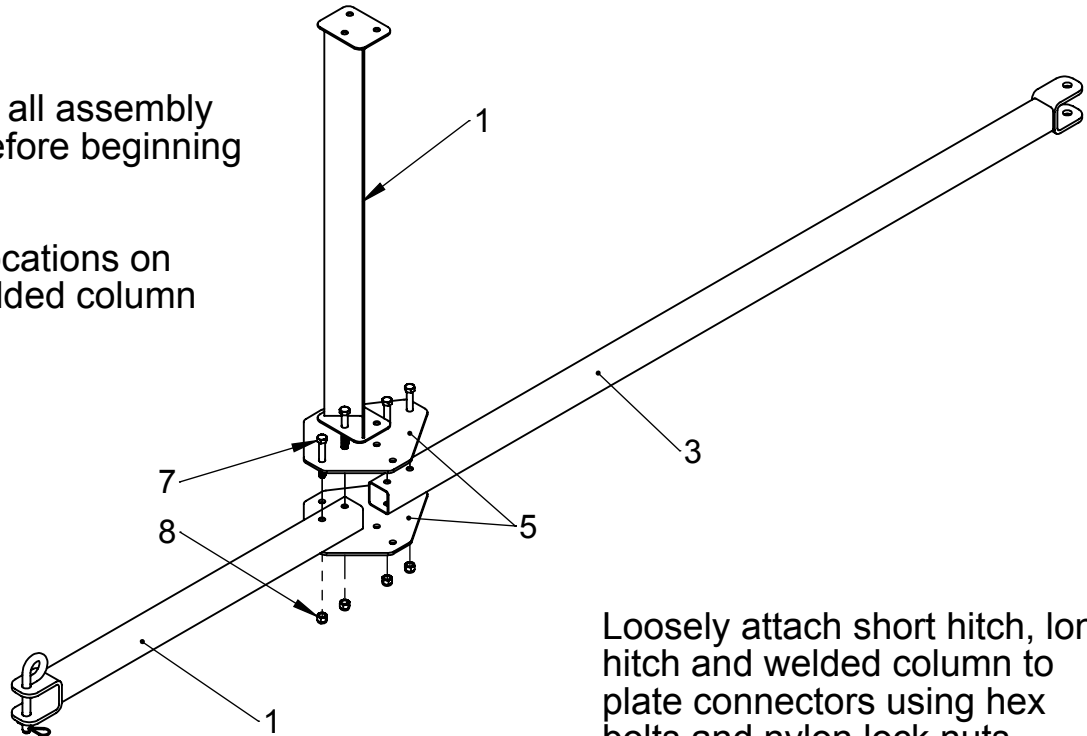

Loosely attach short hitch, long hitch and welded column to plate connectors using hex bolts and nylon lock nuts.

2

Loosely attach hitch tubes to plate connectors using hex bolts and nylon lock nuts.

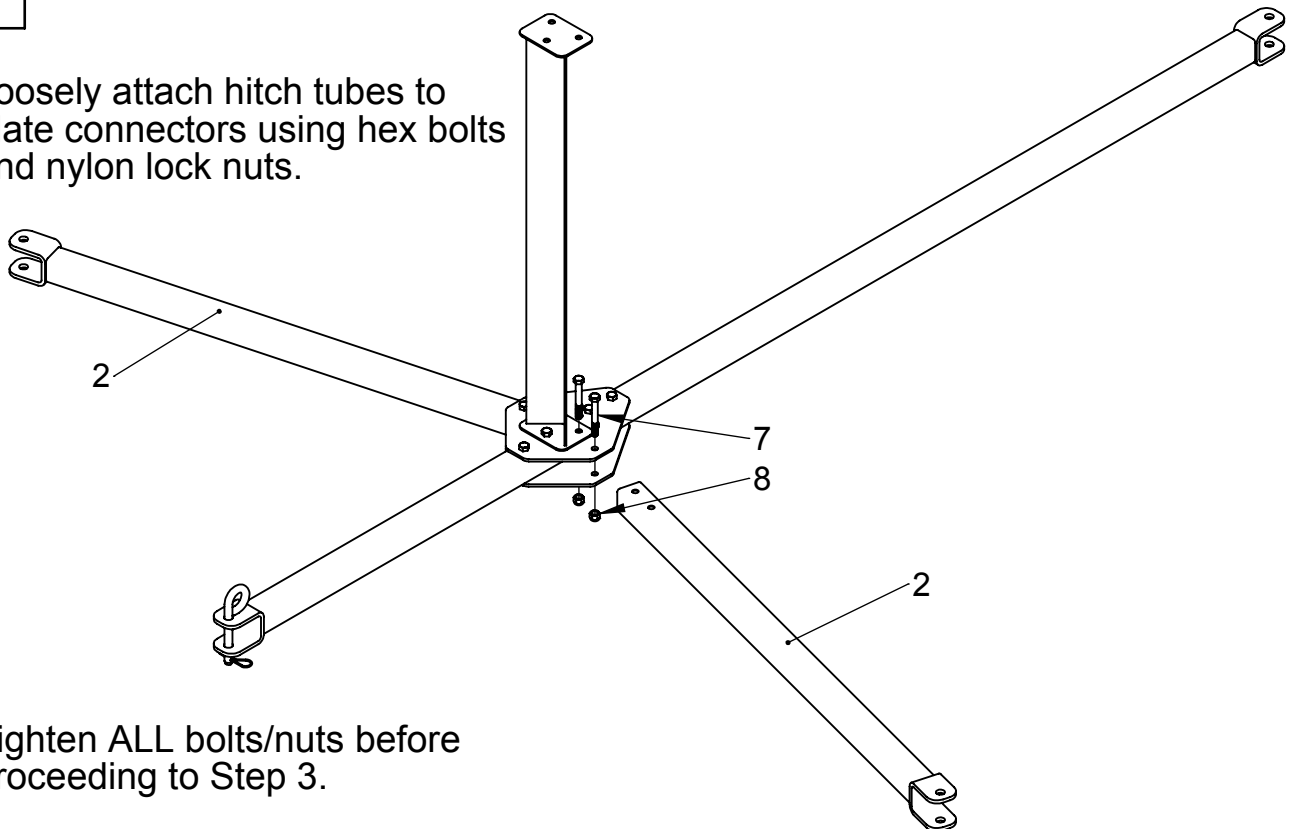

Tighten ALL bolts/nuts before proceeding to Step 3.

Assembly Instructions

3

Attach eyebolts to top of welded column as shown.

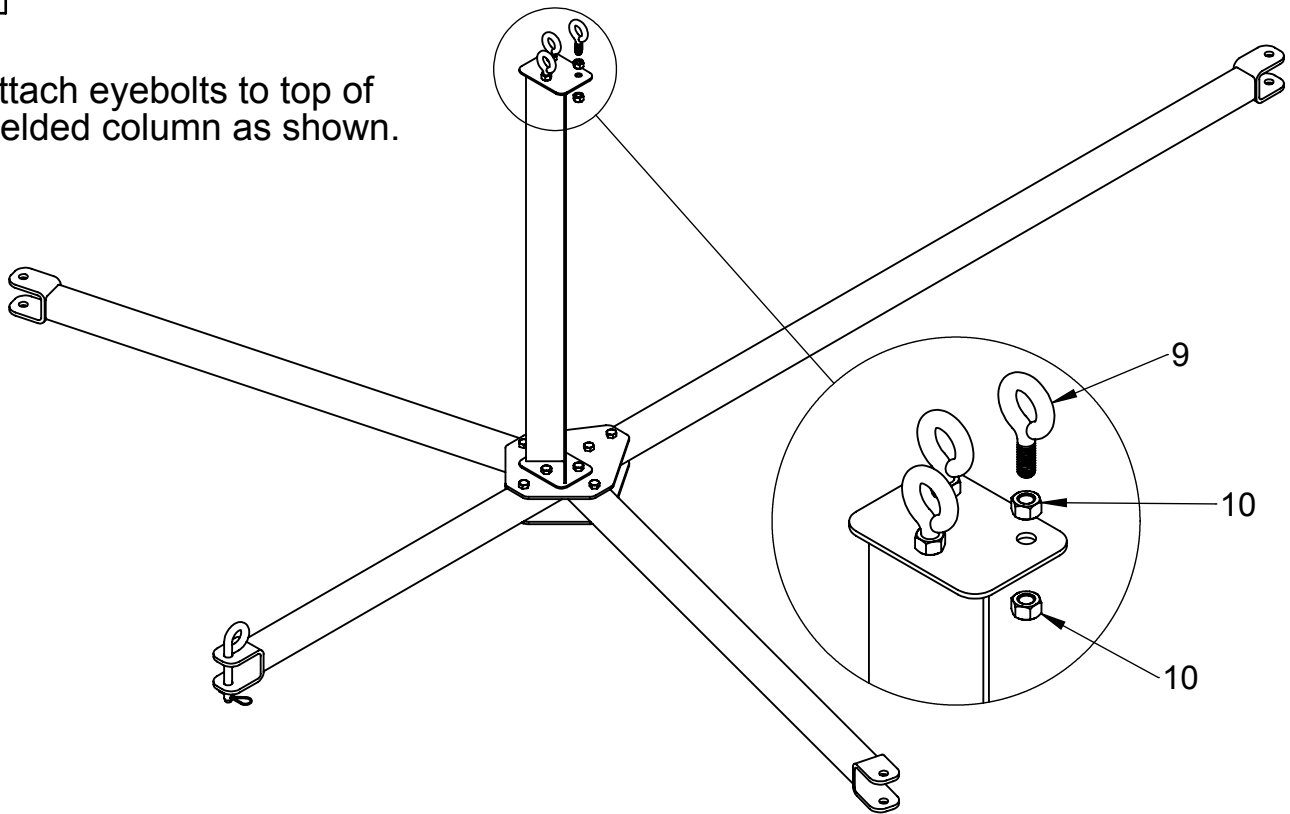

4

Add sweepers to tandem hitch assembly using hitch pins provided with sweepers. Proceed to step 5.

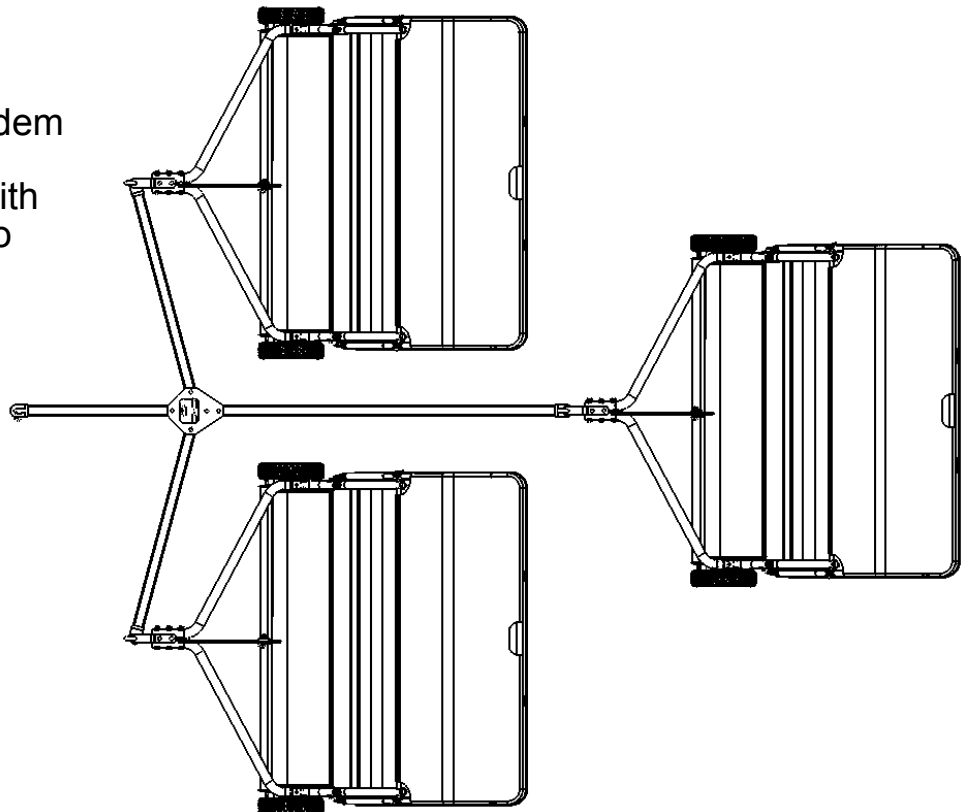

Assembly Instructions

5

Add arm slides to sweepers by removing grip pins on sweeper bag tubes. Align hole in u-clamp of arm slide and re-insert grip pins.

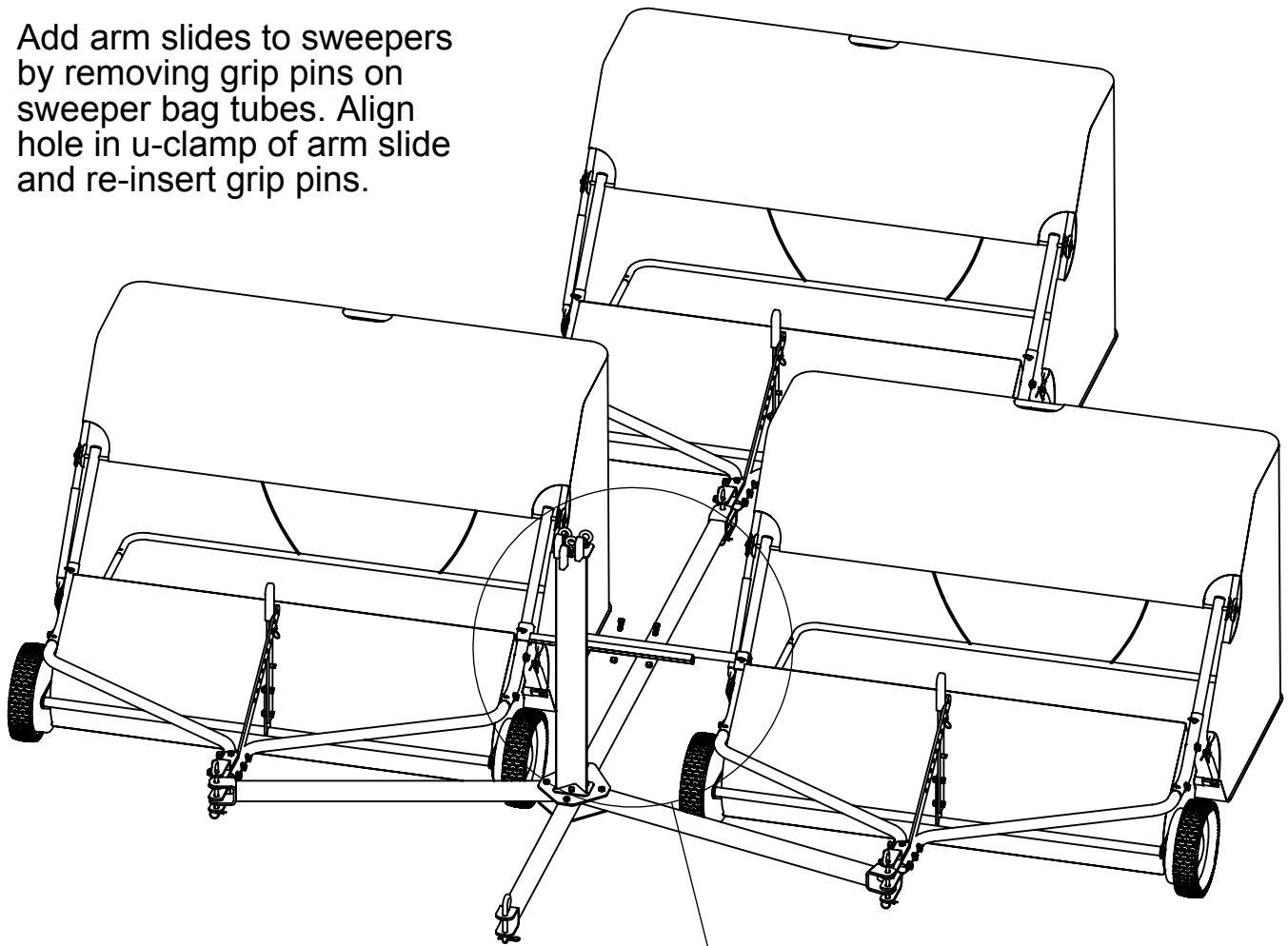

SWEeper GRIP PIN

Secure arm slides with hex bolts and lock nuts provided.

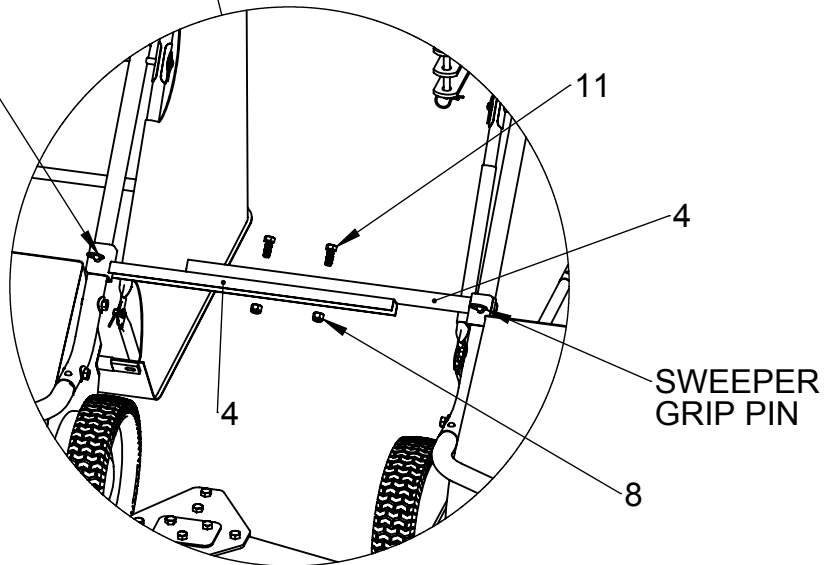

SWEeper GRIP PIN

Assembly Instructions

6

Add rope to Universal Pull handle.
Thread rope through eyebolt and
secure to top rear tube of sweeper bag.

NOTE: leave enough slack in the rope
to allow Universal Pull handle to hang
loose in front of eyebolt.

CAUTION: NEVER allow rope to hang
low enough to get caught in wheels or
brushes.

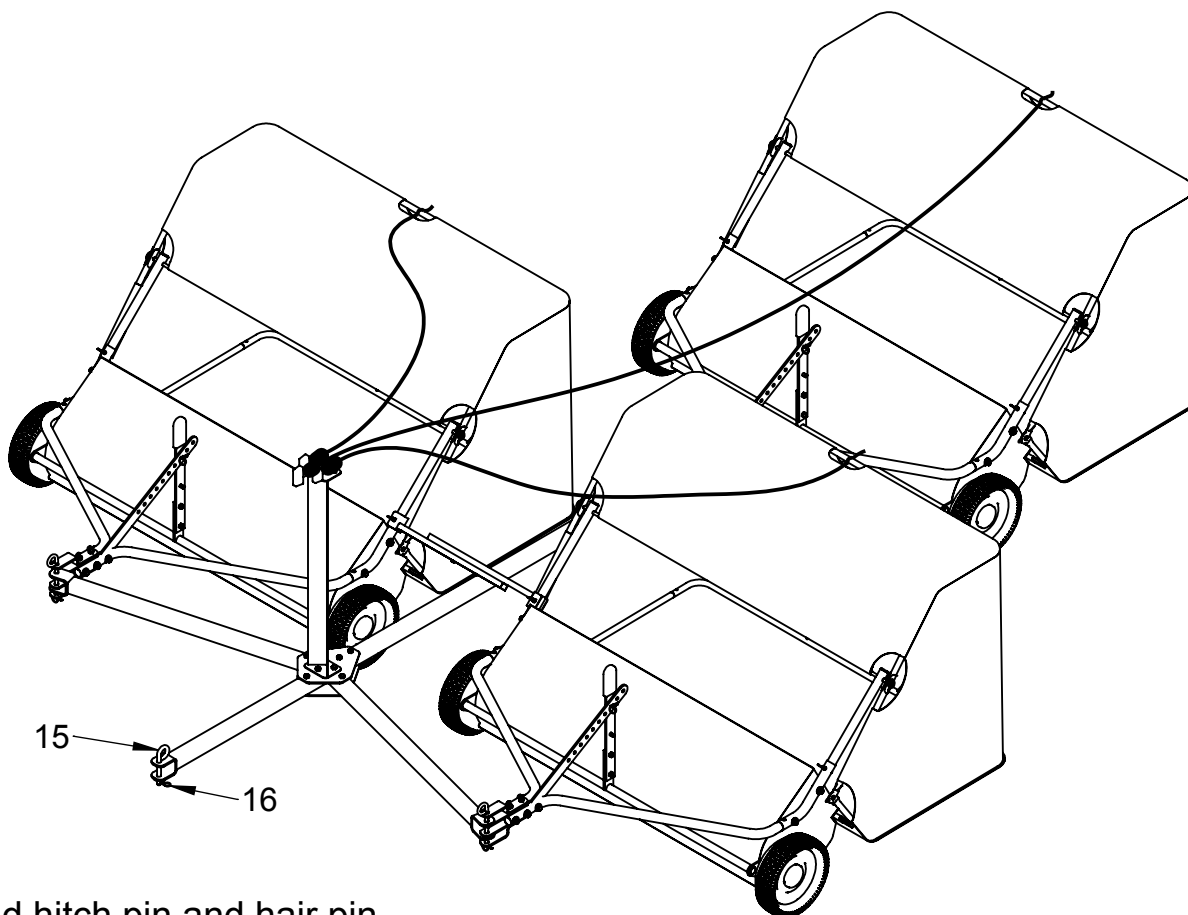
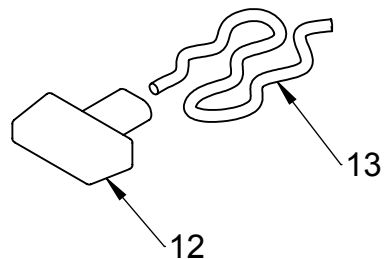

Add hitch pin and hair pin
cotter to attach to tractor.

Warranty

If this product fails due to a defect in material or workmanship within TWO YEARS from the date of purchase, we will at our option repair or replace it free of charge. This warranty excludes tires, wheels, brushes and bag, which are expendable and become worn during normal use.

This warranty does not cover:

- Repairs necessary because of operator abuse or negligence.
- Equipment used for commercial or rental purposes.
- Paint that is worn or faded due to normal use or exposure.

To arrange for product repair call 1-800-652-2321, or return this product to place of purchase for replacement.

This warranty gives you specific legal rights, and you may also have other rights which may vary from state to state. This warranty applies only while this product is in use in the United States.

In the space below record the purchase date of your Lawn Sweeper.

Model Number **RT3HK** _____

Purchase Date _____

Keep this Owner's Manual and your receipt in a safe place for future reference.

After the two year warranty period all replacement parts may be ordered by calling **1-800-652-2321**.

When ordering replacement parts, always give the following information:

- Product **TANDEM HITCH KIT** _____
- Model Number **RT3HK** _____
- Part Number _____
- Part Description _____

Repair Parts

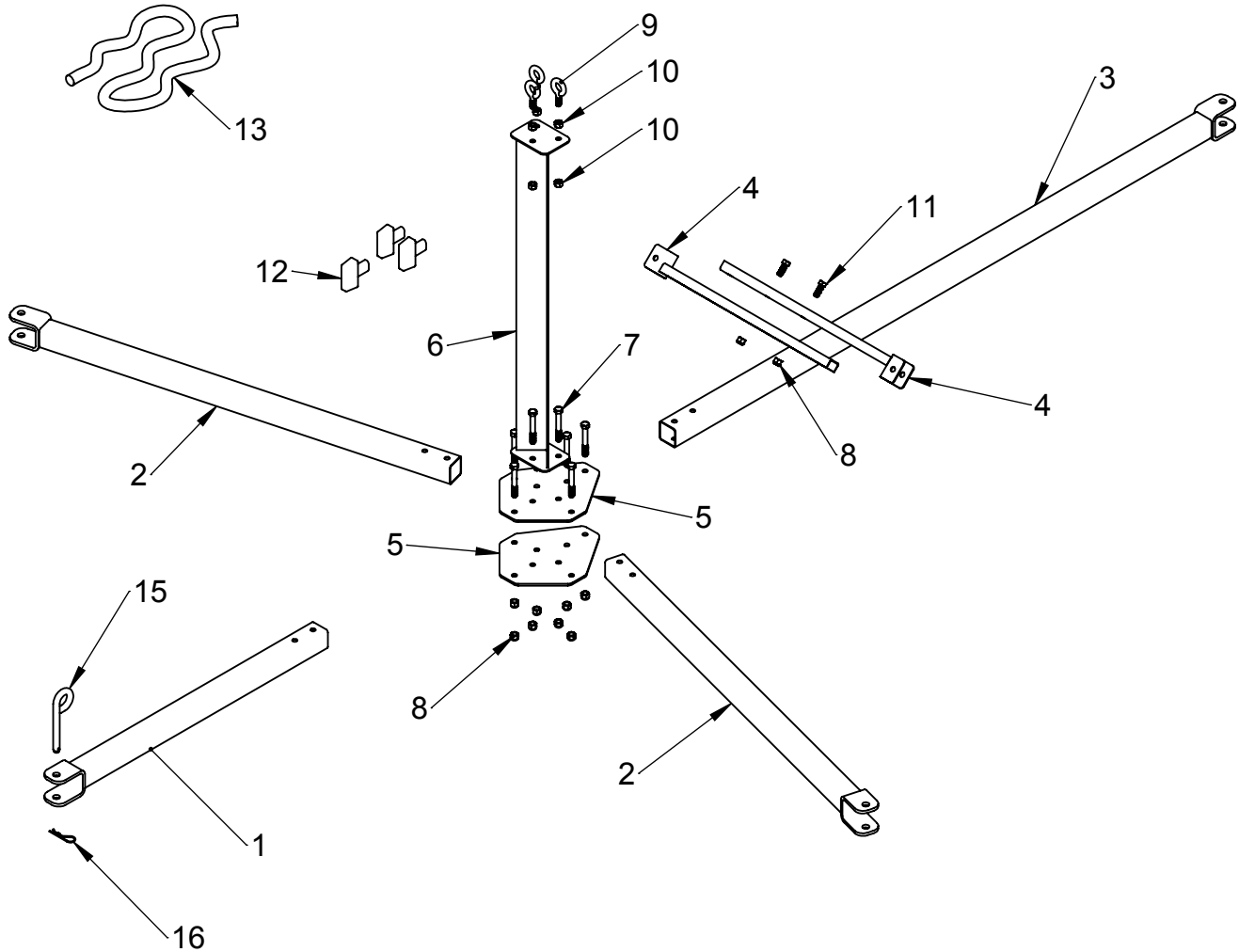

ITEM	PART NO	DESCRIPTION	QTY	ITEM	PART NO	DESCRIPTION	QTY
1	6000848	HITCH, SHORT	1	9	6001605	EYEBOLT, 3/8"	3
2	6000847	HITCH	2	10	300069	HEX NUT, 3/8"	6
3	6000849	HITCH, LONG	1	11	3000511	HEX BOLT, 3/8" X 1"	2
4	6000850	ARM, SLIDE	2	12	6001606	UNIVERSAL PULL HANDLE	3
5	6000842	PLATE, CONNECTOR	2	13	6001608	ROPE, 16'	1
6	6000851	COLUMN, WELDED	1	14	6001607	INSTRUCTION MANUAL	1
7	3000531	HEX BOLT, 3/8" X 2-3/4"	8	15	6000533	HITCH PIN	1
8	3000618	HEX NUT, 3/8" NYLOCK	10	16	300084	HAIR PIN COTTER	1
				17	6001610	HARDWARE BAG	1



Designed And Tested In Columbus, Ohio

Manufactured In The U.S.A. From Domestic
And Imported Components



MODEL # RT3HK

2575 Ferris Road Columbus, OH 43224
(800) 652-2321

www.ohiosteel.com
(800) 652-2321