

Repair Parts

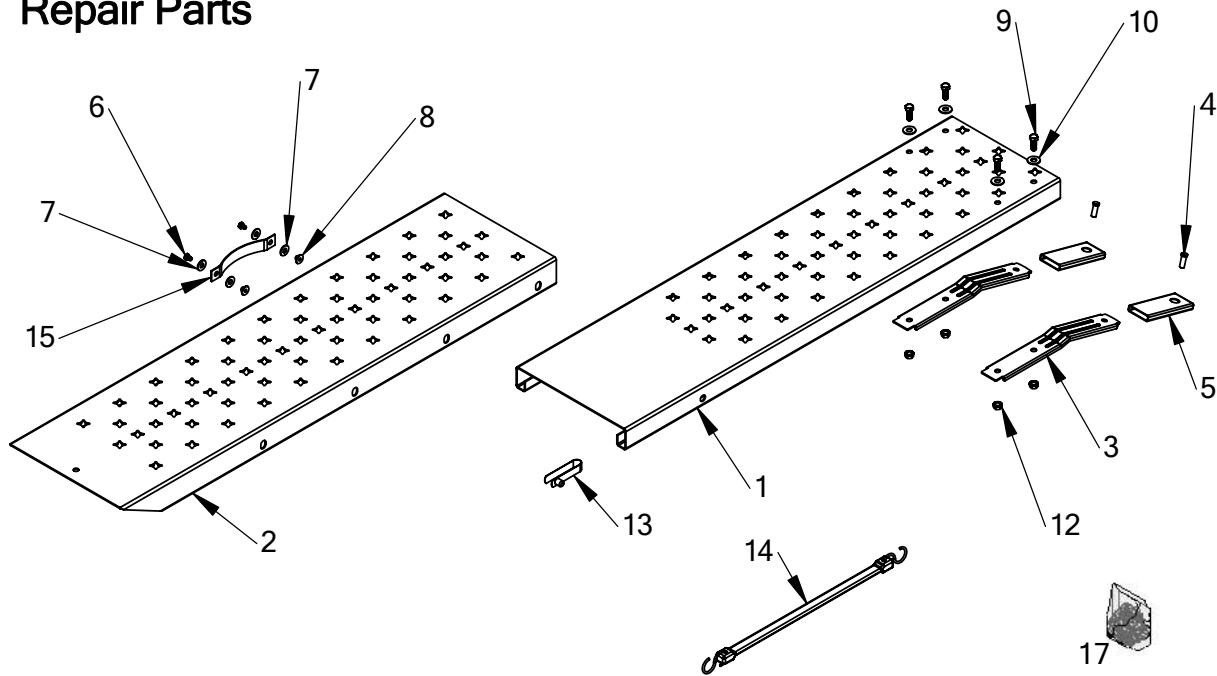

OHIO STEEL INDUSTRIES

TELESCOPING ALUMINUM ATV LOADING RAMP

Model 1084TR

- 625 pound capacity - single.
- 1,250 pound capacity - double.
- Compact Storage.
- Assembly required.
- One person loading.

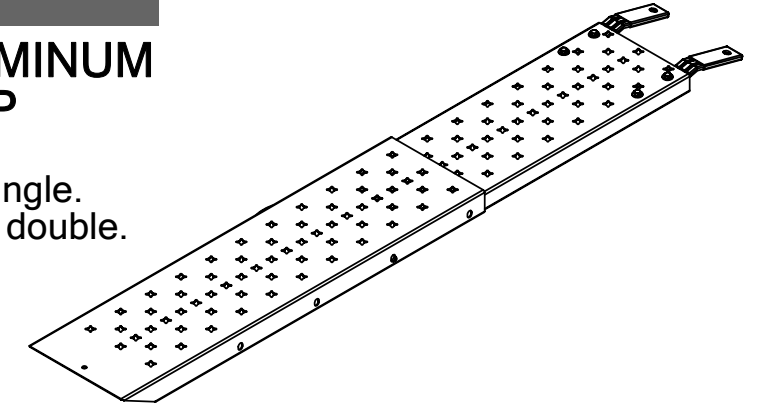

Manufactured under U.S. Patent No. 5,645,394

WARNINGS

- The loading ramp surfaces are sharp. Always wear proper clothing and use care when handling the loading ramps. (Gloves are strongly recommended).
- Read and understand all safety and operating instructions before using the loading ramp. **Never** allow anyone unfamiliar with these instructions to use the loading ramps.
- Read and understand all safety and operating instructions provided by the manufacturer of the equipment the loading ramp will be used with.
- Extreme caution should always be used while loading and unloading your equipment.
- **Do not** exceed the rated capacity of the loading ramp.
- **Do not** exceed the rated capacity of the loading surface (i.e. tailgate). If unknown, contact the manufacturer to find the maximum load capacity.
- Never stand in the path of equipment being loaded, and keep all bystanders and children away from loading ramps.
- This ramp must be only used for loading and unloading to and from a level and stable surface.
- Use caution when using ramp in icy or wet conditions. The ramp surface may become slippery.
- **Do not** use this loading ramp to load live animals.
- **Do not** use loading ramps as a bridge, scaffolding, or any other use for which it is not intended or designed.
- If ramp is bowing while loading or unloading your equipment, which indicates an overload condition, remove the equipment immediately.
- **Do not** attempt to load or unload any power equipment with its motor running.
- Failure to follow these warnings may result in property damage and/or serious bodily injury.

REF. NO	PART NO.	AMT.	DESCRIPTION	REF. NO	PART NO.	AMT.	DESCRIPTION
1	84TR-01	1	RAMP TOP	10	STDWF375USS	4	3/8" FLAT WASHER
2	84TR-02	1	RAMP BOTTOM	12	STDNK370	4	3/8"-16 KEPS NUT
3	LR-03	2	SUPPORT BAR	13	84TR-13	1	SNAP BUTTON (A-190S)
4	LR-04	2	CLEVIS PIN	14	LR-14	1	BUNGEE W/S-HOOK
5	LR-05	2	SUPPORT BAR PADS	15	84TR-15	1	NYLON HANDLE
6	STDBH2500375	2	1/4"-20 X 3/8" BOLT	16	84TR-16	1	MANUAL - NOT SHOWN
7	STDWF250USS	4	1/4" FLAT WASHER	17	84TR-17	1	HARDWARE BAG - NOT SHOWN
8	84TR-08	2	1/4"-20 T-NUT	18	84TR-18	1	WARNING DECAL - ON RAMP
9	STDBH3750750	4	3/8"-16 X3/4" BOLT				

LIMITED ONE-YEAR WARRANTY

REV-B

If this product fails due to a defect in material or workmanship within one year from the date of purchase, Ohio Steel will at its option repair or replace it free of charge. **Proof of purchase required for all warranty claims.**

This warranty does not cover:

- Repairs necessary because of operator abuse or negligence.
- Equipment used for commercial or rental purposes.

Contact Ohio Steel to arrange for product repair, or return this product to place of purchase for replacement.

This warranty gives you specific legal rights, and you may also have other rights which vary from state to state. This Warranty applies only while this product is in use in the United States.

When ordering repair parts always give the following information, PRODUCT NAME, MODEL NUMBER, PART NUMBER, and PART DESCRIPTION.

Ohio Steel Industries
Columbus, OH 43224 U.S.A.
Visit our website: www.ohiosteel.com

For missing parts or questions
Call 1-800-652-2321