

# **OHIO**STEEL®

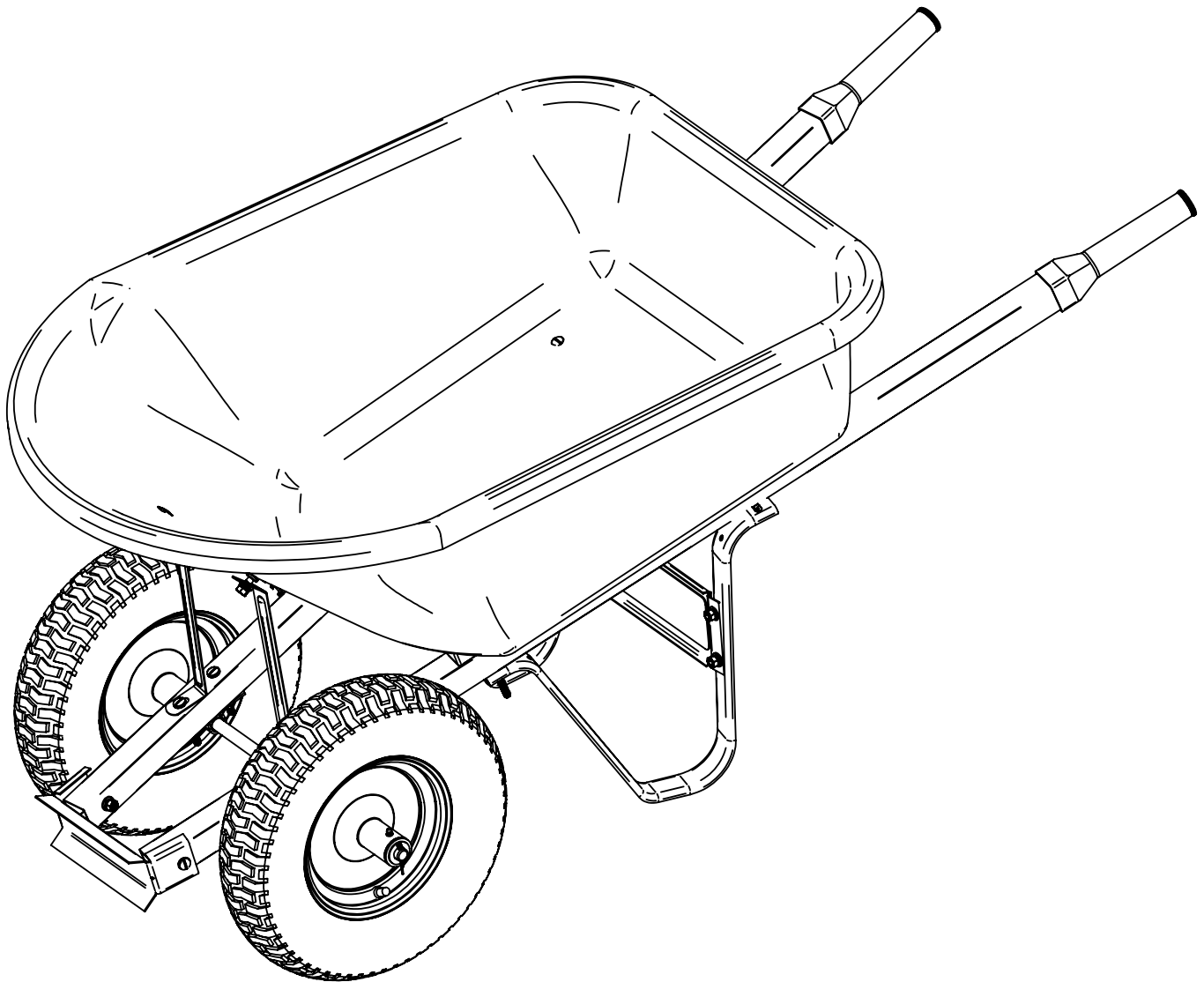

## **6PWB350**

## **6 cu ft POLY WHEELBARROW**



**READ AND FOLLOW ALL SAFETY RULES AND OPERATING  
INSTRUCTIONS BEFORE USING THIS EQUIPMENT**

# ***Safety Rules***



**This is the safety alert symbol. It is used to alert you to potential personal injury hazards. Obey all safety messages that follow this symbol to avoid possible injury or death.**

Read and understand all safety rules and operating instructions before using this equipment.

Never allow children or untrained persons to operate this piece of equipment.

Do not exceed the operator's physically capable weight limit.

Reduce operator speed and allow extra stopping distance when handling heavy loads.

Reduce operator speed and handling weight when operating on slopes.

Operate up and down slopes, never across the face of slopes.

Do not carry passengers in equipment.

Avoid sudden turns or maneuvers.

Do not use equipment on public roadways.

Do not remove warning decals from product.

Check product for worn, loose, or damaged parts before each use. If any damage is present, repair the product before using.

Check product for loose or missing fasteners before each use. Tighten or replace fasteners as needed before using.

Do not exceed operators capable locomoting speed when moving loads with equipment.

Do not exceed equipments rated weight capacity of 350 pounds.

Use cation when backing up to prevent personal injury or product damage.

Never tow product from a vehicle.

Watch for traffic when using product near roadways.

Wear appropriate protective equipment while using product, including but not limited to closed toed shoes, safety glasses, and gloves.

# ***Warranty***

## **IF YOU ARE MISSING PARTS DO NOT RETURN TO STORE**

Email [cs@ohiosteel.com](mailto:cs@ohiosteel.com) or call 1-800-652-2321, ext. 212

**Attach Receipt Here:**

**Before you call, please email our customer service team at [cs@ohiosteel.com](mailto:cs@ohiosteel.com) with the following:**

1. A description of the issue you are having
2. Photos of the issue that include an overall view and detailed view from multiple angles
3. If applicable, a short video showing the issue

### **Replacement Parts:**

**You can place your parts order online at [ohiosteel.com/partsstore](http://ohiosteel.com/partsstore)**

- You can also reach our Customer Service Department at 1-800-652-2321, ext. 212
- If you are ordering replacement part(s) for your product, please note that some parts are only available as a repair kit.

If this product fails due to a defect in material or workmanship within THREE YEARS from the date of purchase, we will at our option, only with receipt of purchase, repair or replace it free of charge. This warranty excludes tires, bushings, and handle grips which are expendable and become worn during normal use.

### **This warranty does not cover:**

- Repairs necessary because of operator abuse or negligence.
- Equipment used for commercial or rental purposes.
- Paint that is worn or faded due to normal use or exposure.
- Product degradation or failure due to corrosion or its affects.

To arrange for product repair visit [ohiosteel.com/customer-support](http://ohiosteel.com/customer-support) and fill out the warranty repair form. You can also call 1-800-652-2321, ext. 212 to speak to our Customer Service Team

This warranty gives you specific legal rights, and you may also have other rights which may vary from state to state. This warranty applies only while this product is in use in the United States.

# Carton Contents

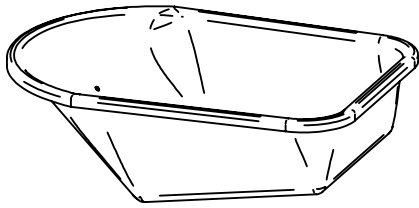

1 (x1)

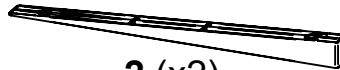

2 (x2)

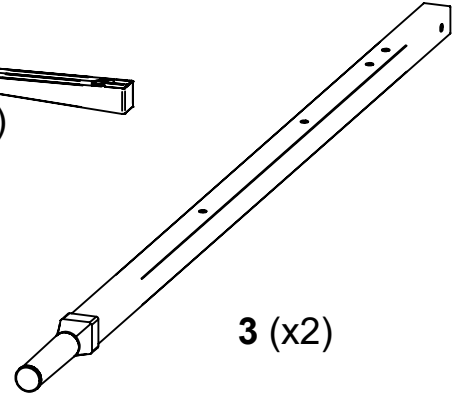

3 (x2)

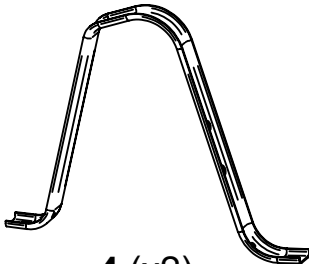

4 (x2)



5 (x1)

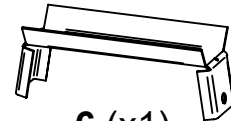

6 (x1)



7 (x2)

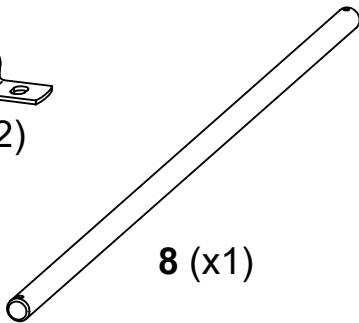

8 (x1)

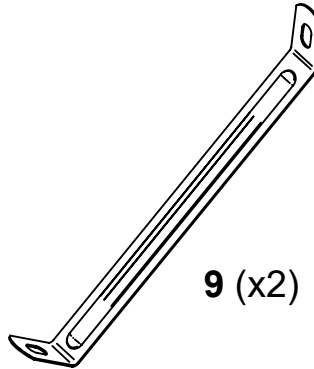

9 (x2)



10 (x2)

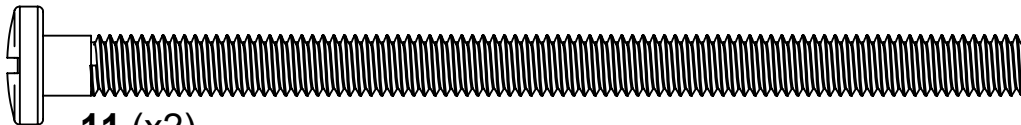

11 (x2)

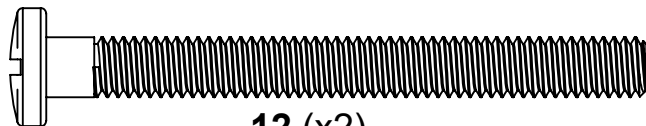

12 (x2)

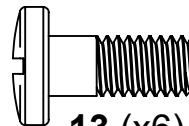

13 (x6)

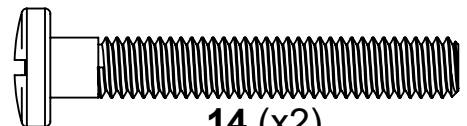

14 (x2)

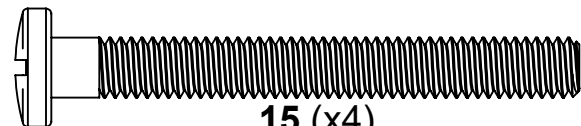

15 (x4)

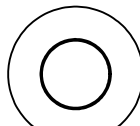

16 (x16)

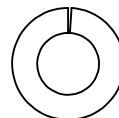

17 (x16)

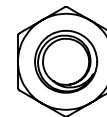

18 (x16)

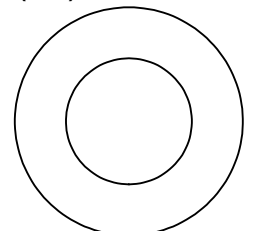

19 (x2)

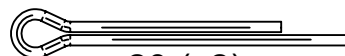

20 (x2)

## TOOLS REQUIRED FOR ASSEMBLY:

- 1/2" Wrench or Deep Well Socket • Flat Head Screwdriver • Pliers

# Assembly Instructions

**1**

Lay Body (1) on side. Insert 5-1/8" Bolt (11) through front holes in body (1) and 3-1/8" Bolt (12) through rear holes in Body (1). Slide Body Shims (2) over Bolts (11 & 12) with thicker section aiming to front of body.

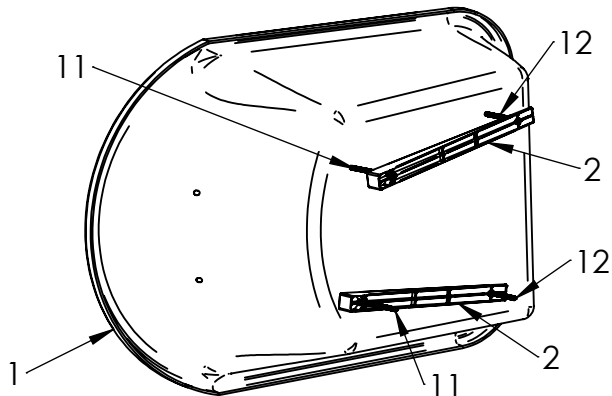

Assembly Tip: Temporarily secure bolt head to body with tape.

**2**

Slide Handles (3) over Bolts (11 & 12).

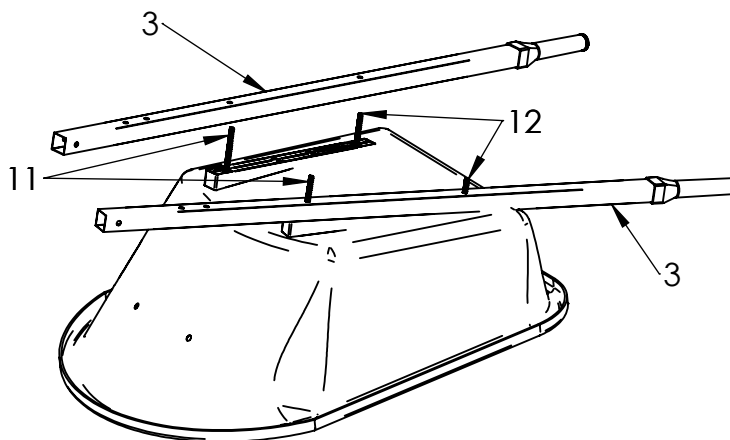

**3**

Slide Legs (4) over Bolts (11 & 12). Install Washer (16), Split Washer (17), and Hex Nut (18) hand tight. DO NOT tighten hardware until final step.

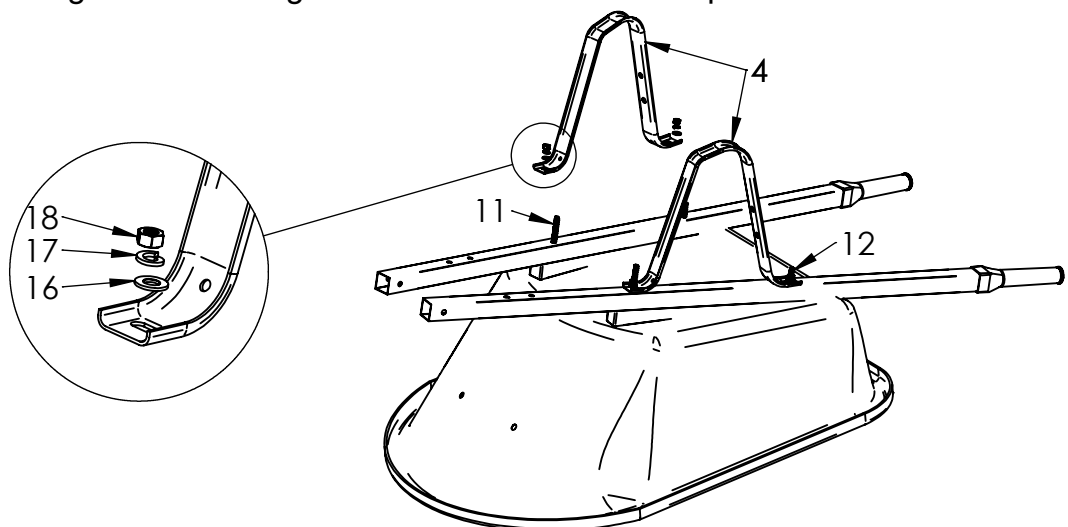

# Assembly Instructions

**4**

Install Formed Plate (5) onto Legs (4) with 3/4" Bolt (13), Washer (16), Split Washer (17), and Hex Nut (18) hand tight. DO NOT tighten hardware until final step.

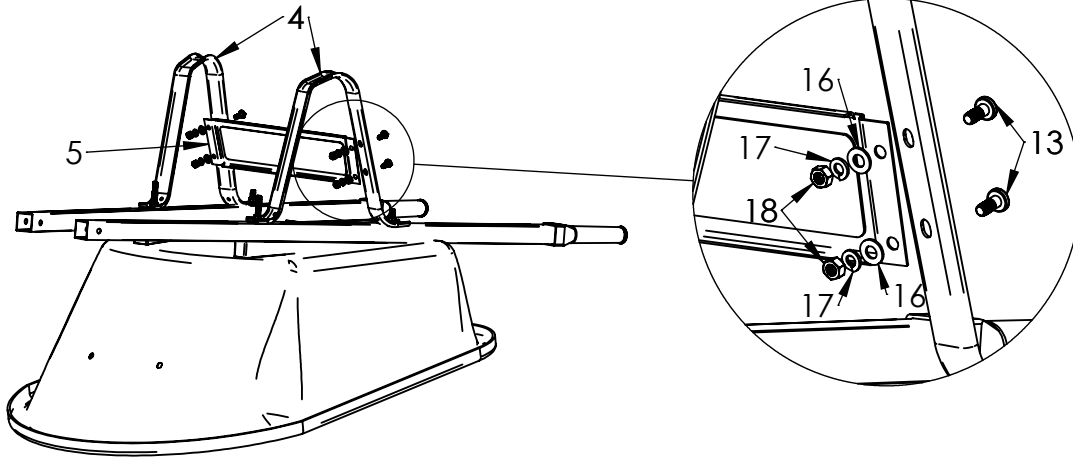

**5**

Install Dump Bracket (6) onto Handles (3) with 2-1/8" Bolts (14), Washer (16), Split Washer (17), and Hex Nut (18) hand tight. DO NOT tighten hardware until final step.

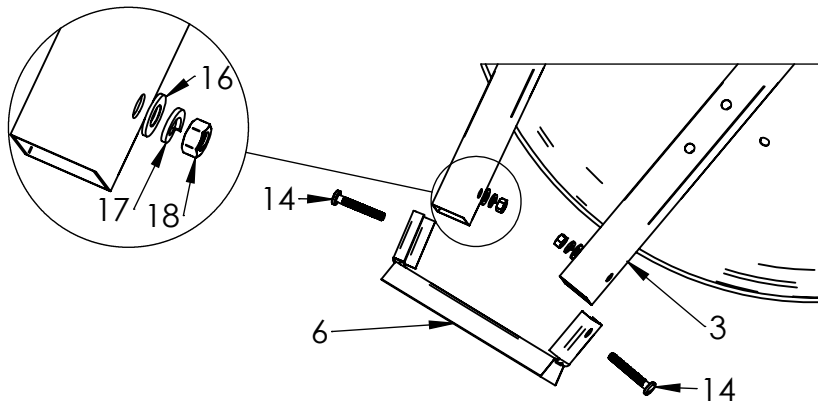

**6**

Insert 2-3/4" Bolt (15) through holes furthest away from the Dump Bracket (6) in Wheelbarrow Handles (3). Place Axle Retainers (7) over Bolt (15). Secure by installing Washer (16), Split Washer (17), and Hex Nut (18) hand tight. Slide Axle (8) into place. DO NOT tighten hardware until final step.

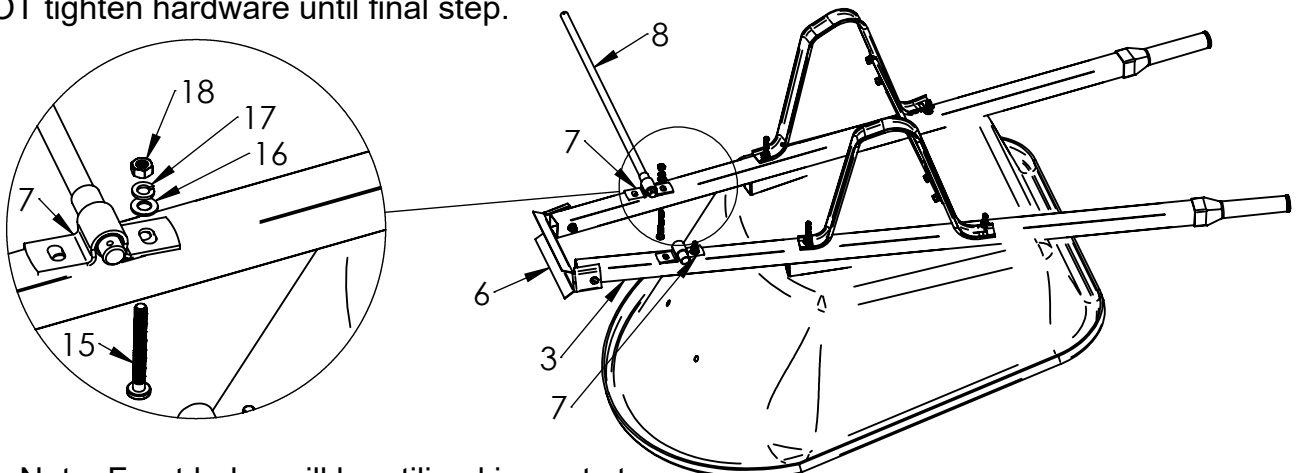

Assembly Note: Front holes will be utilized in next step.

# Assembly Instructions

**7**

Install 2-3/4" Bolt (15) through Body Supports (9) hole on the side with non-obtuse angle. Continue to push Bolt (15) through Handle (3) and Axle Retainer (7). Secure by installing Washer (16), Split Washer (17), and then Hex Nut (18) hand tight. DO NOT tighten hardware until final step.

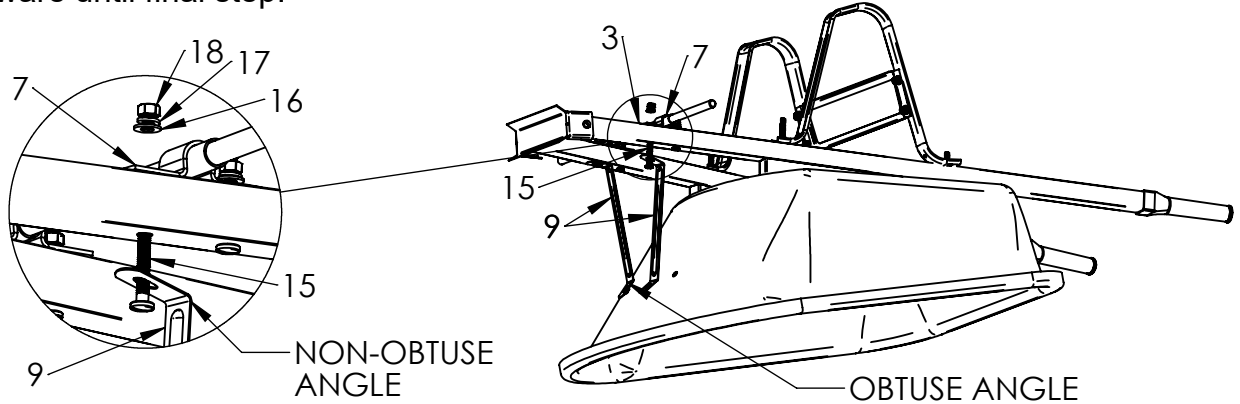

**8**

Insert 3/4" Bolt (13) through Body (1). Push Body Support (9) over Bolt (13). Secure by installing Washer (16), Split Washer (17), and then Hex Nut (18) hand tight. All parts and hardware are now in place. Tighten all hardware in order of install.

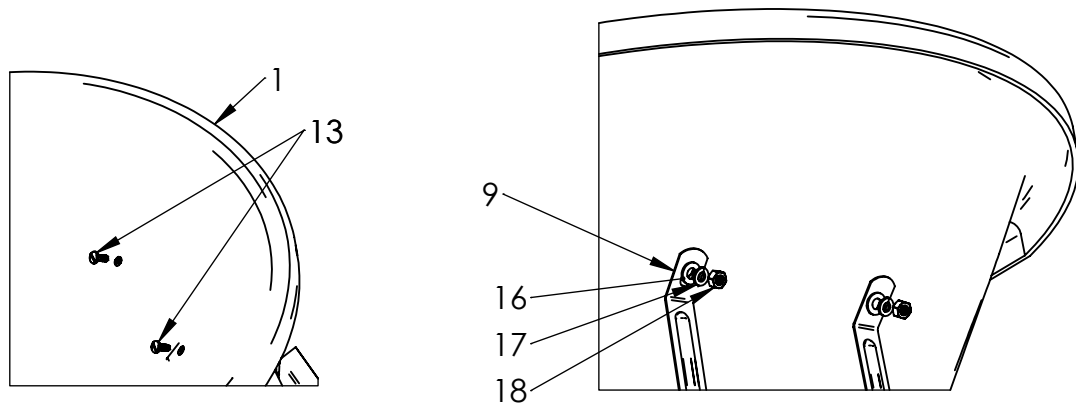

**9**

Push Wheel (10) over Axle (8) until they contact Axle Retainer (7). Slide Washer (19) over Axle (8). Insert Cotter Pin (20) through hole at end of Axle (8) and secure by bending legs.

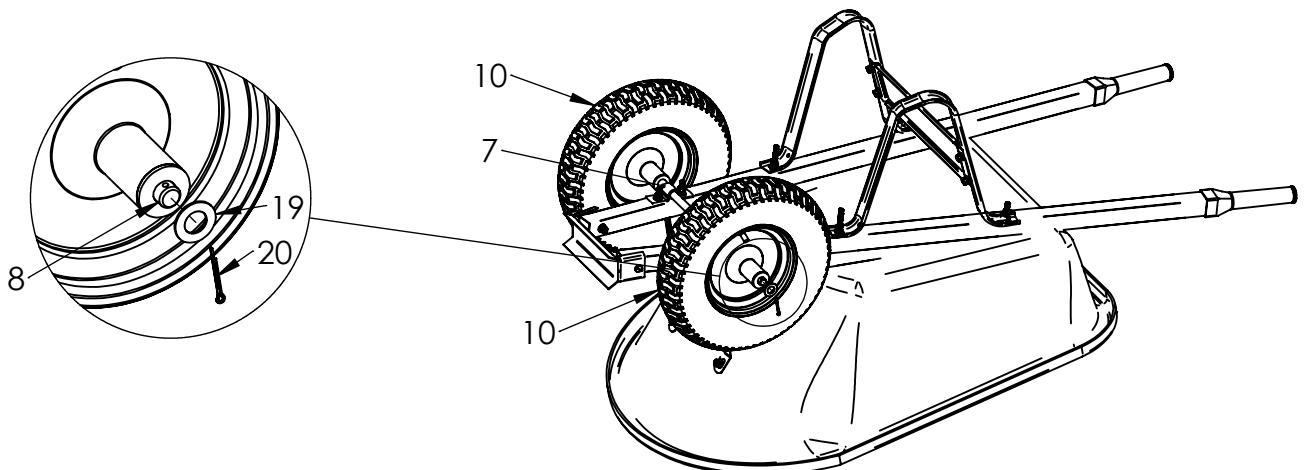

# ***Operating Instructions***

## **Before Using Dump Cart:**

1. Apply grease to wheels using grease gun until grease can be seen squeezing out from both sides of the wheel.
2. Check tire pressure and inflate to recommended PSI listed on sidewall.
3. Read all Safety Rules found on page 1.

## **How to Use Wheelbarrow:**

1. Use proper lifting technique when lifting from wheelbarrow handles.
2. Do not exceed 350 pounds when loading material into the body.
3. Distribute the weight of the load as evenly as possible in the body for best handling.
4. When hauling heavy loads, verify that weight does not exceed operator's ability.

## **How to Empty Wheelbarrow:**

1. Lift up on handles and use dump point bracket as a pivot.
2. Lift the body and swivel as desired to guide the material to preferred location.
3. Lift the body entirely and empty material.
4. Lower handles and rest wheelbarrow on legs.

## **Periodic Maintenance:**

- Tighten fasteners as needed before each use
- Check tire pressure before each use
- Grease wheels annually



# EXPLODED VIEW

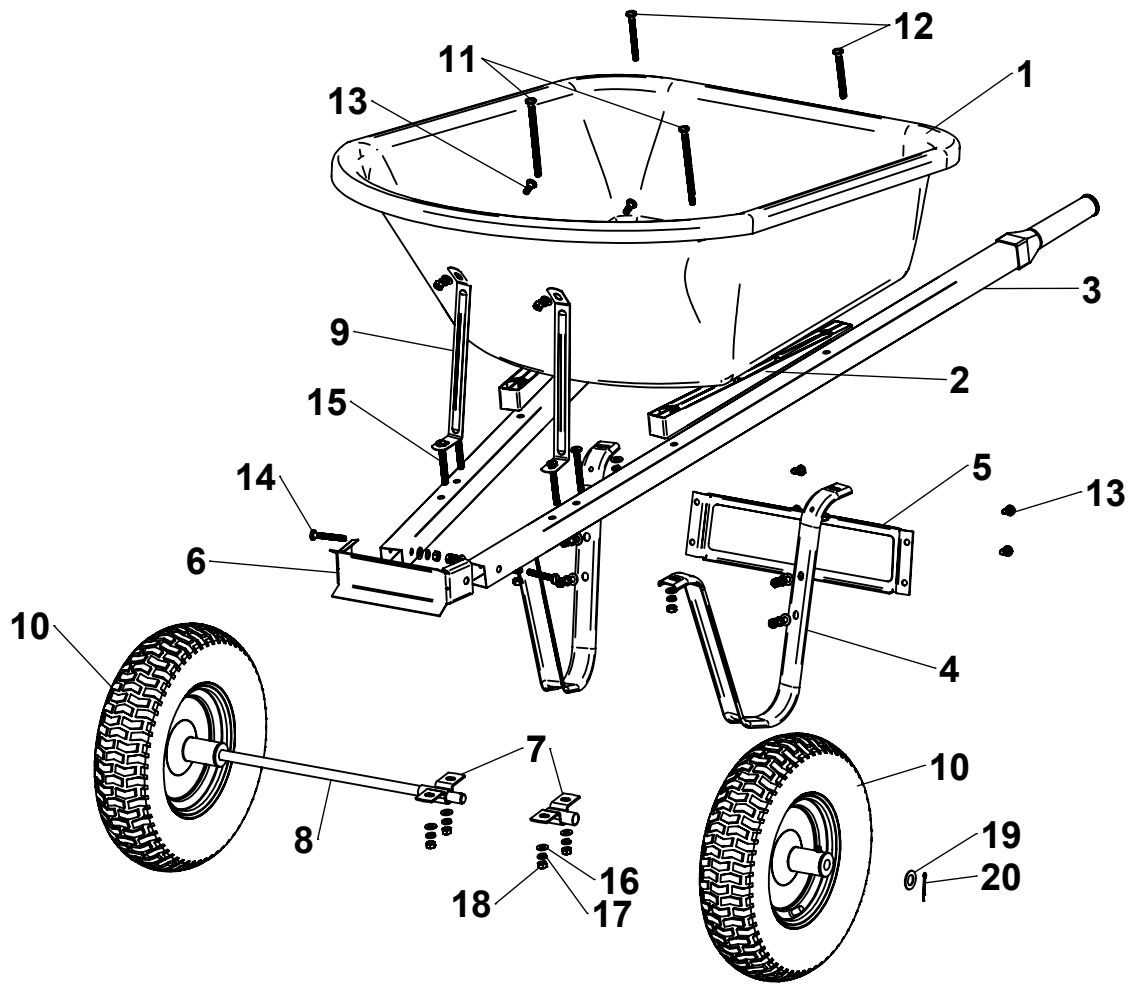

ITEM NO.	PART NUMBER	DESCRIPTION	QTY.
1	6005787	BODY, POLYMER, 6PWB350	1
2	6005799	BODY, SHIM, WB	2
3	6005888	ASSEMBLY, WHEELBARROWS, HANDLE	2
4	6005800-B1	LEG, FORMED, WB (BLACK)	2
5	6005802-B1	PLATE, FORMED, WB (BLACK)	1
6	6005789-B1	BRACKET, DUMP POINT, WB (BLACK)	1
7	6005854-B1	RETAINER, PWB AXLE, 5/8" (BLACK)	2
8	6005788	AXLE, 5/8" X 24-7/16"	1
9	6005807-B1	SUPPORT, BODY, WB (BLACK)	2
10	6005796	WHEEL, 4.80-8 X 3/4" (SILVER)	2
11	6006082-ZC	BOLT, PAN, 5/16"-18 X 5-1/8" (ZINC)	2
12	6006083-ZC	BOLT, PAN, 5/16"-18 X 3-1/8" (ZINC)	2
13	6006086-ZC	BOLT, PAN, 5/16"-18 X 3/4" (ZINC)	6
14	6006085-ZC	BOLT, PAN, 5/16"-18 X 2-1/8" (ZINC)	2
15	6006084-ZC	BOLT, PAN, 5/16"-18 X 2-3/4" (ZINC)	4
16	6006088-ZC	WASHER, 5/16" (ZINC)	16
17	6006089-ZC	WASHER, SPLIT, 5/16" (ZINC)	16
18	6006090-ZC	NUT, HEX, 5/16"-18 (ZINC)	16
19	6006087-ZC	WASHER, 5/8" (ZINC)	2
20	6006091-ZC	PIN, COTTER, 7/64" X 1-1/8"	2

# **OHIO**STEEL®



7 16504 84001 0

**MODEL # 6PWB350**



Proudly designed and  
tested in Columbus, Ohio

Manufactured in the U.S.A from  
domestic and imported components

