

OHIOSTEEL®

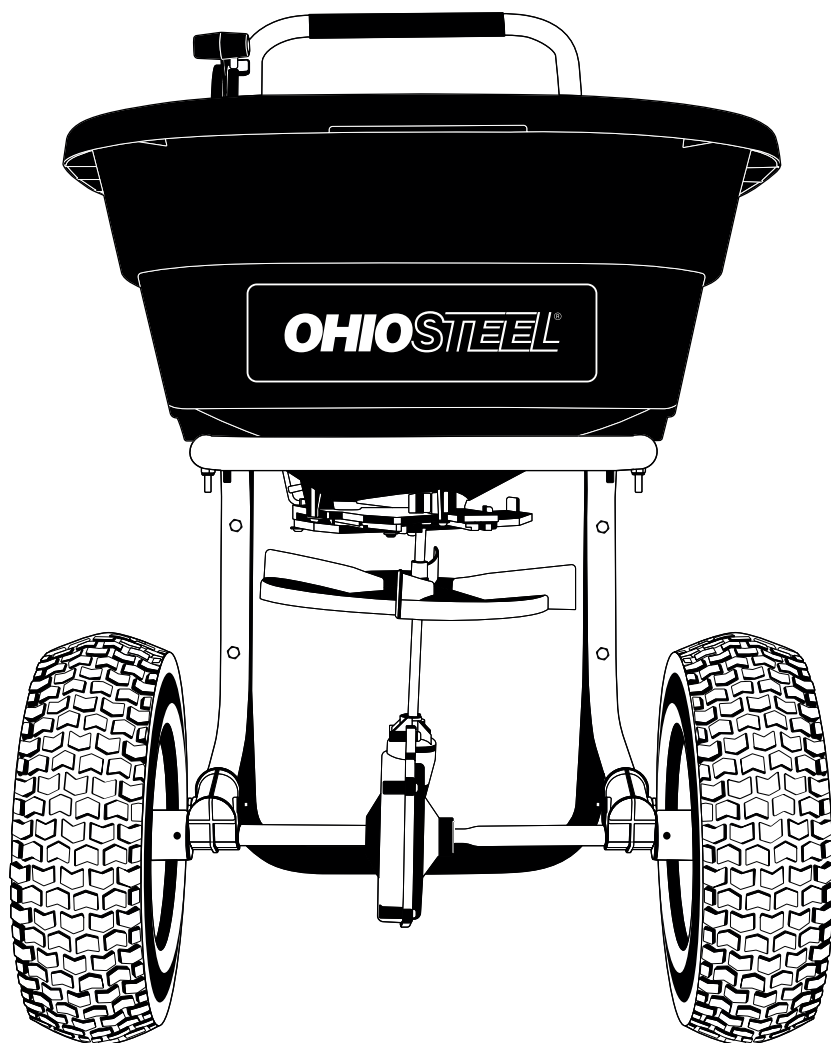

SCAN HERE
MORE PRODUCT INFO



10PPS100

FERTILIZER AND SALT SPREADER



**READ AND FOLLOW ALL SAFETY RULES AND OPERATING
INSTRUCTIONS BEFORE USING THIS EQUIPMENT**

6005890 - REV A - 03/23

Safety Rules



This is the safety alert symbol. It is used to alert you to potential personal injury hazards. Obey all safety messages that follow this symbol to avoid possible injury or death.

Read and understand all safety rules and operating instructions before using this product.

Never allow children or untrained persons to operate product.

Operate across the face of slopes, never up and down slopes.

Do not carry passengers on product.

Avoid sudden turns or maneuvers.

Use caution when backing up to prevent personal injury or product damage.

Do not use product on public roadways.

Do not remove warning decals from product.

Check product for worn, loose, or damaged parts before each use. If any damage is present, repair the product before using.

Check product for loose or missing fasteners before each use. Tighten or replace fasteners as needed before using.

Always completely stop product before completing any maintenance.

Wear appropriate protective equipment while using product, including but not limited to closed toe shoes, safety glasses, and gloves.

Watch for traffic when using product near the roadway.

Do not reach into any areas in product with moving or rotating surfaces.

Operate with a reduced speed in rough terrain and hills to prevent tipping or loss of control.

Never tow this product from a vehicle.

Warranty

IF YOU ARE MISSING PARTS DO NOT RETURN TO STORE

Email cs@ohiosteel.com or call 1-800-652-2321, ext. 212

Attach Receipt Here:

Before you call, please email our customer service team at cs@ohiosteel.com with the following:

1. A description of the issue you are experiencing.
2. Photos of the issue that include an overall view and detailed view from multiple angles.
3. If applicable, a short video showing the issue.

Replacement Parts:

You can place your parts order online at ohiosteel.com/partsstore

- You can also reach our Customer Service Department at 1-800-652-2321, ext. 212
- If you are ordering replacement part(s) for your product, please note that some parts are only available as a repair kit.

If this product fails due to a defect in material or workmanship within THREE YEARS from the date of purchase, we will at our option, only with receipt of purchase, repair or replace it free of charge. This warranty excludes tires, wheels, brushes and bag, which are expendable and become worn during normal use.

This warranty does not cover:

- Repairs necessary because of operator abuse or negligence.
- Equipment used for commercial or rental purposes.
- Paint that is worn or faded due to normal use or exposure.
- Product degradation or failure due to corrosion or its effects.

To arrange for product repair visit **ohiosteel.com/customer-support** and fill out the warranty repair form. You can also call 1-800-652-2321, ext. 212 to speak to our Customer Service Team.

This warranty gives you specific legal rights, and you may also have other rights which may vary from state to state. This warranty applies only while this product is in use in the United States.

Carton Contents

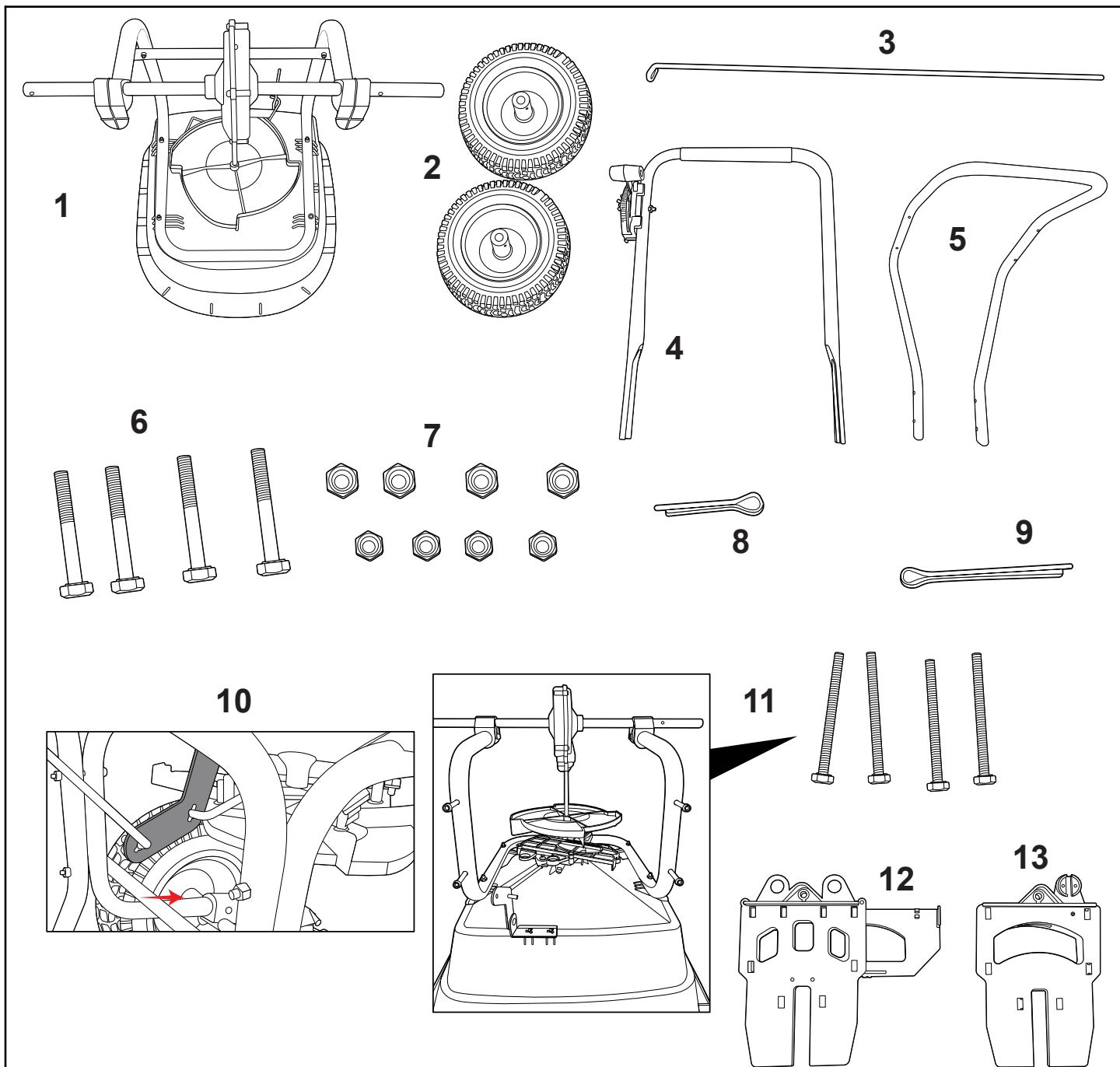

PARTS LIST:

- | | | | |
|----|-----------------------|-----|-----------------------|
| 1. | Hopper Body & Frame | 8. | Small Cotter Pin |
| 2. | Pneumatic Wheels (X2) | 9. | Large Cotter Pin |
| 3. | Control Rod | 10. | Pivot Bracket |
| 4. | Handle Bar | 11. | M6 x 65 Bolts (X4) |
| 5. | Back Stand | 12. | Summer Material Plate |
| 6. | M6 x 45 Bolts (X4) | 13. | Winter Material Plate |
| 7. | M6 Lock Nuts (X8) | | |

TOOLS REQUIRED FOR ASSEMBLY:

- Screwdriver
- 10mm Wrench or Socket

Assembly Instructions

1

Place the Hopper body (1) on the table so that the gearbox is pointing upwards. Remove the nuts and the bolts from the main frame (1). Keep this hardware, it will be used in Step 2.

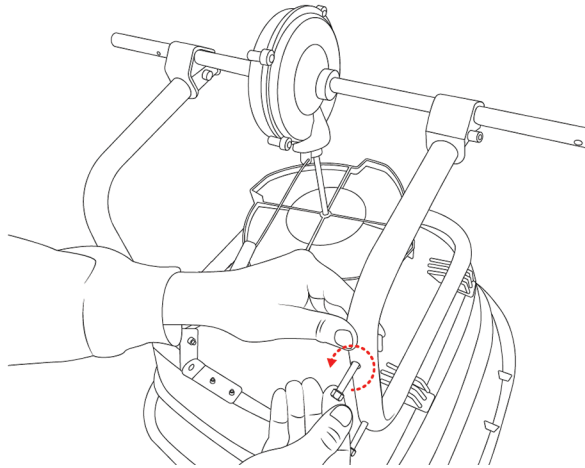

2

Take the back stand (5) and align it with the holes on the main frame (1). Thread bolts and add lock nuts in the four bolt locations. Use a wrench to tighten the lock nuts.

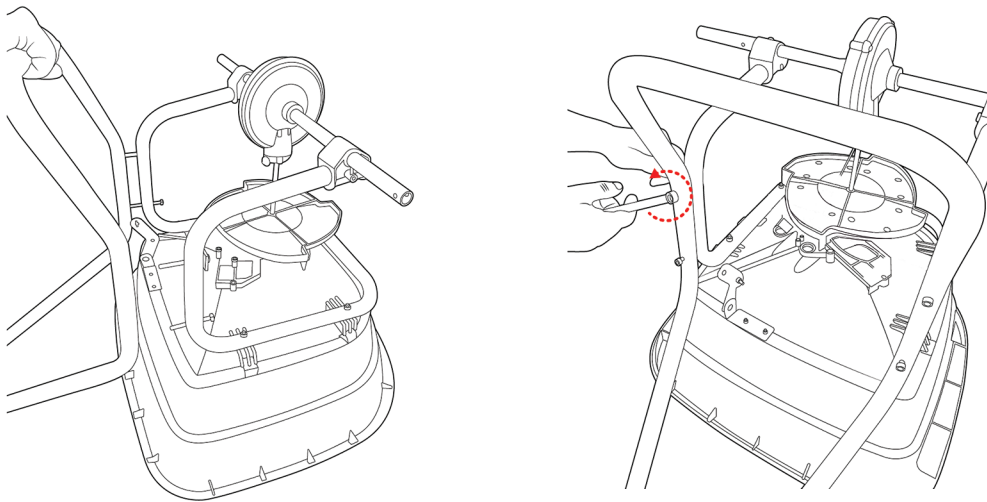

3

Gather the wheels (2) and the two cotter pins (8 & 9) from the hardware bag. Check that the wheels are inflated to the correct PSI. Slide them over the axles on each side of the main frame (1).

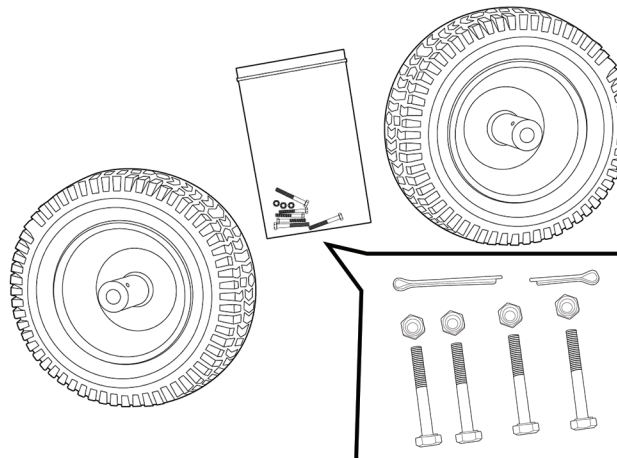

Assembly Instructions

4

Align the hole on the inside of the pneumatic wheel (2) with the hole on the axle. Take the large cotter pin (9) and thread it through the two holes. Bend the legs of the cotter pin to secure in place.

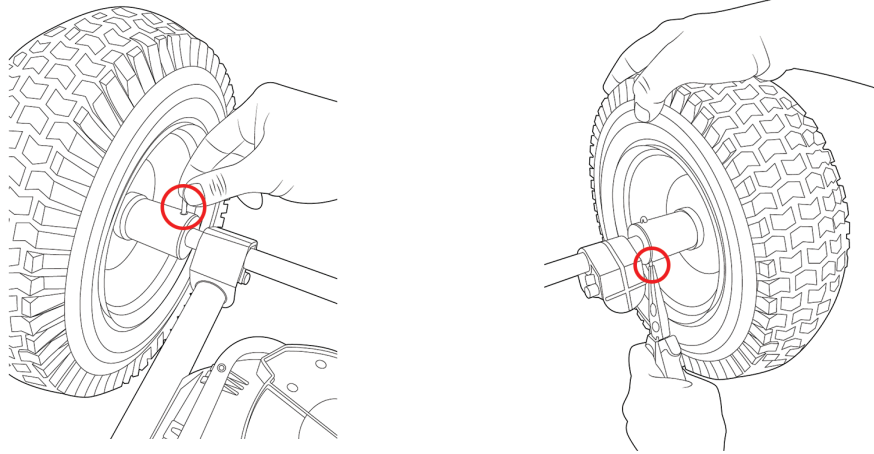

5

Take the small cotter pin (8) and place it through the hole on the outside of the opposite wheel. Bend the legs of the cotter pin to secure in place.

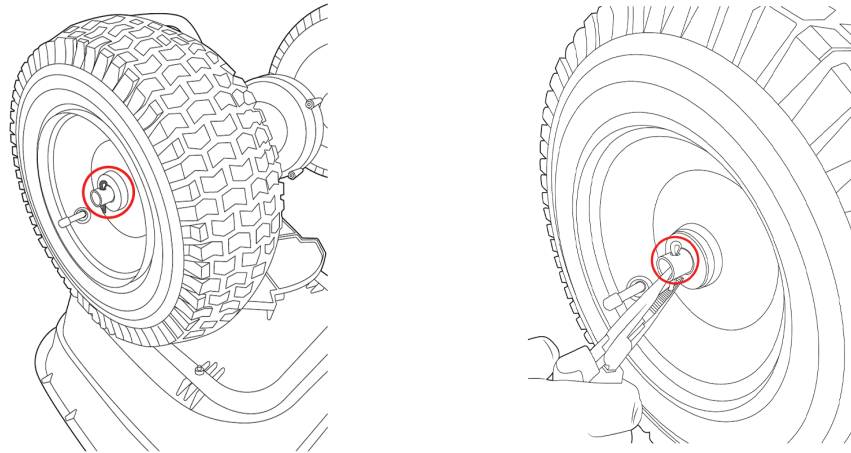

6

Turn the hopper body and main frame (1) over so that the spreader sits on its wheels. Take the handle bar and slide it down the two ends of the back stand. Align the holes between the components as shown.

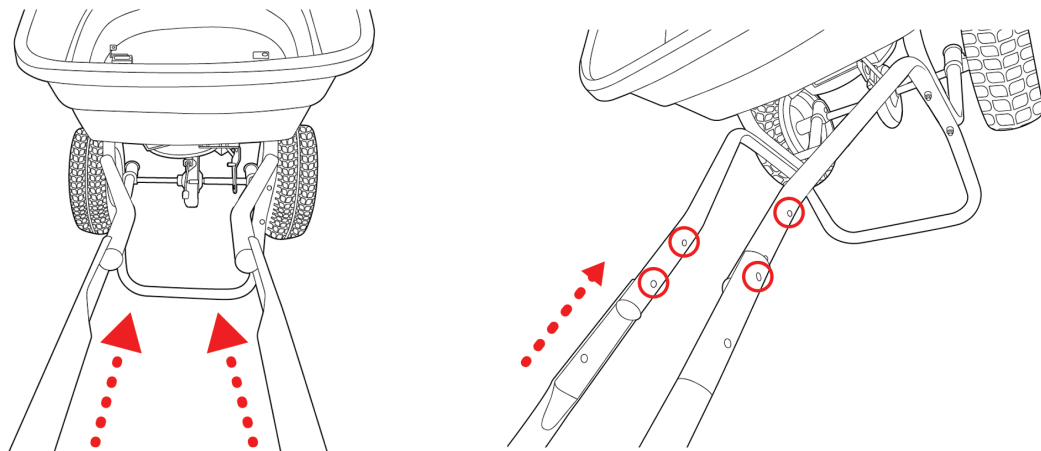

Assembly Instructions

7

Thread the four remaining bolts (6) through the holes on the handle bar (4) and the back stand (5). Add locknuts and tighten.

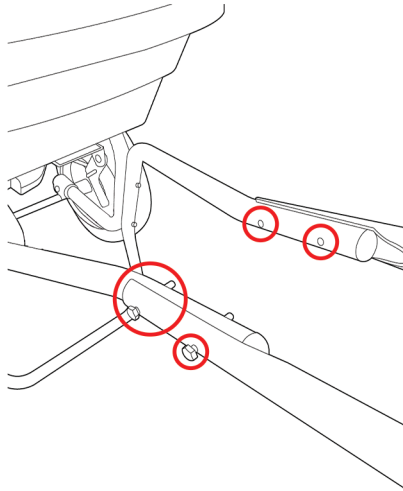

8

Take the bent end of the control rod (3) and thread it through the hole at the back of the pivot bracket. The rod will lock into place.

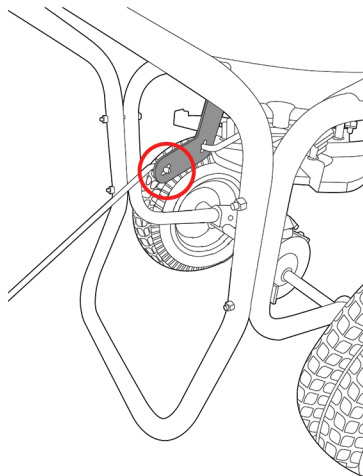

9

Feed the other end of the control rod (3) and align it with the hole on the on/off mechanism of the handle bar (4). Ensure you push the lever all the way to the bottom to its 20 position and then hand tighten the screw.

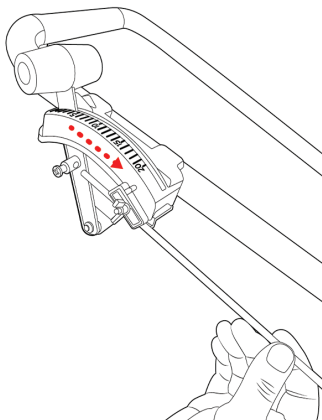

Assembly Instructions

10

Check that the application holes in the hopper is fully open. You should see the entirety of the holes (or one large hole) on the slide system. See reference below. Once confirmed, then tighten the control rod (3).

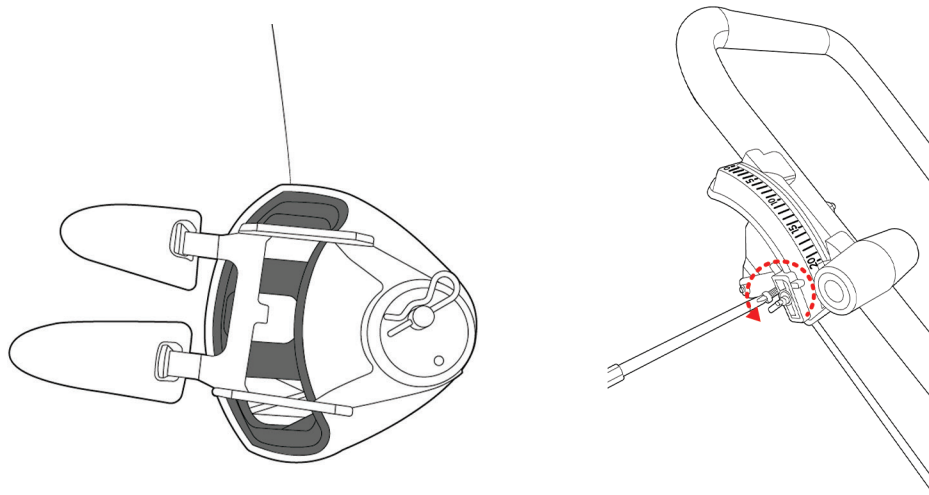

11

Assembly is complete. Check tire pressure and ensure that all hardware is tightened prior to use.

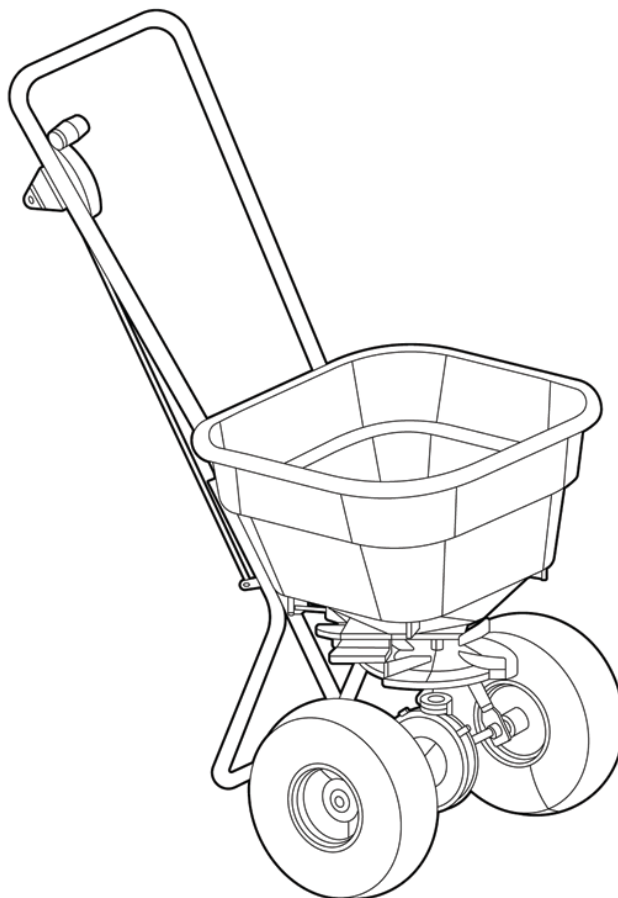

Operating Instructions

Walking Patterns for the optimum application (For Fertilizer Only)

There are two methods of effective spreading, longitudinal fertilizer spreading and cross sectional fertilizer spreading.

A

Single Pass Fertilizer Spreading

Use ½ the application rate suggested on the back of your fertilizer bag.

Cover the area as shown by passing over it in an up and down track as shown, taking into account the spread width of the material being applied.

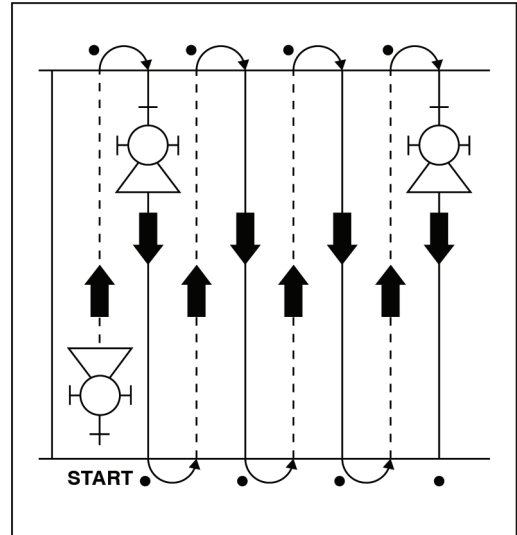

B

Cross Sectional Fertilizer Spreading

Use ½ the application rate suggested on the back of your fertilizer bag.

Cover the area as shown. Repeating by a second pass in the same manner going across the area as shown in the diagram.

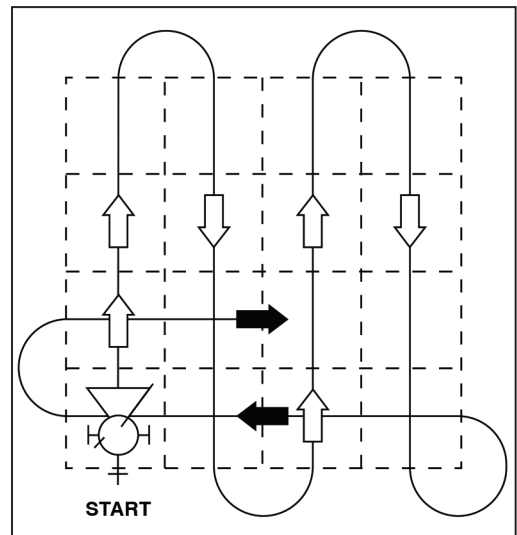

How to Swap Over the Material Plates

1

Use these instructions only if you are replacing the material plate on the finished unit. Place the finished unit onto a table so that the back of the spreader is easily accessible. Shown below.

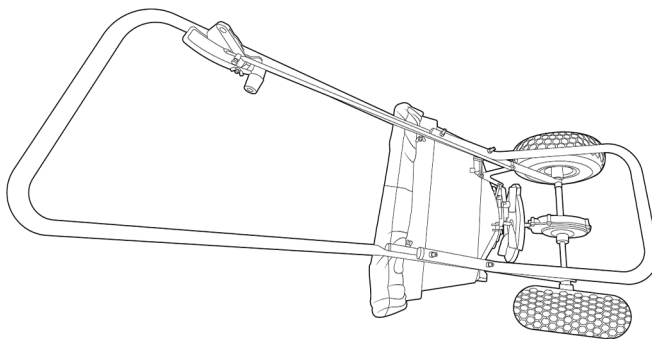

2

Locate cotter pin (24) near the assembled material plate (20/23) below the hopper body (17) and remove it. Keep this pin for later assembly.

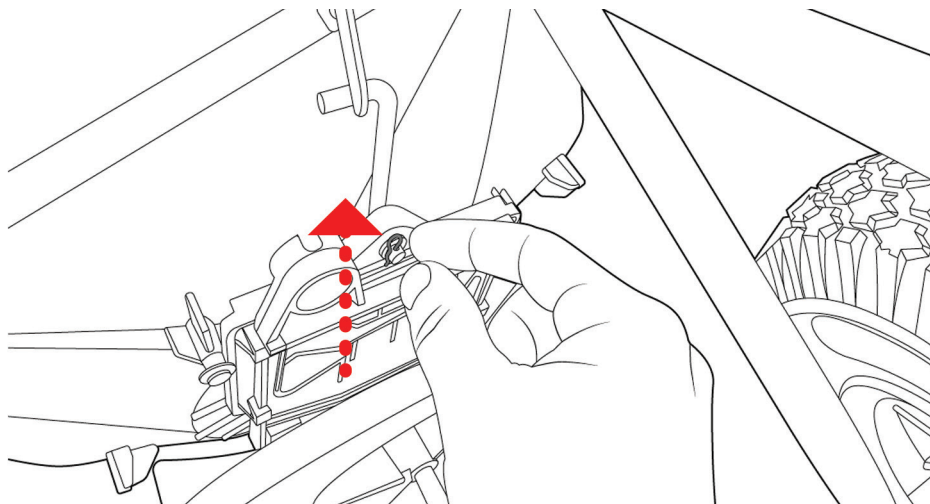

3

Press the top of the pivot bracket (21) so the material plate is pushed back and the pivot rod (16) is loosened.

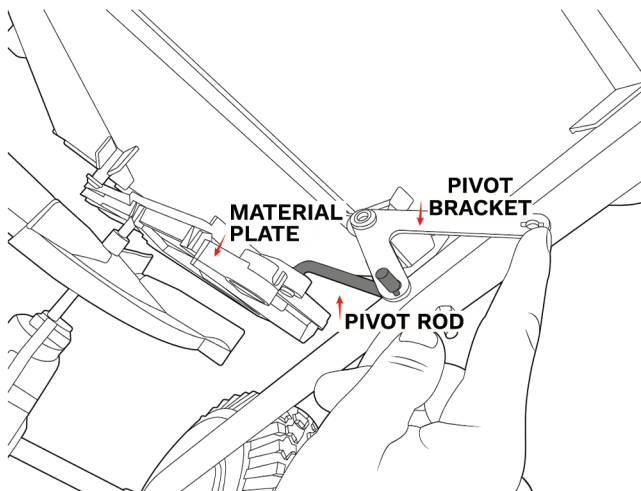

How to Swap Over the Material Plates

4

Remove the pivot rod end (16) by pushing the tip through the hole at the top of the material plate (20/23). Then, remove the material plate and store it for next use.

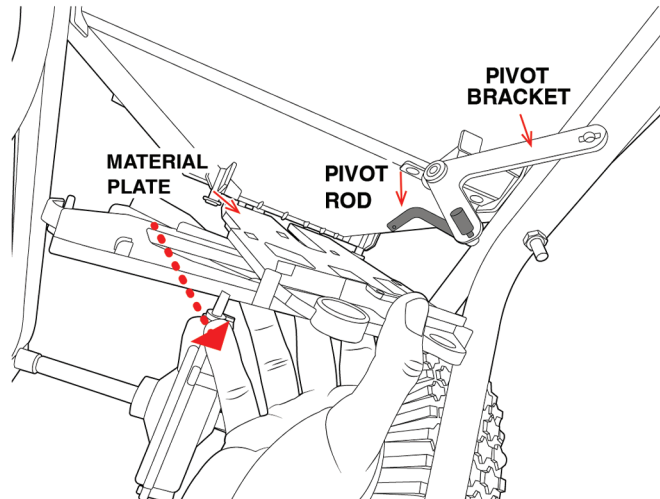

5

After removing the old material plate, locate the new material plate and reinstall it into the grooves on the bottom of the hopper body (17). After installation, the material plate should be secure and sit level underneath the hopper. Ensure that the plate slides smoothly in and out of the grooves. (Summer Material plate is shown as an example).

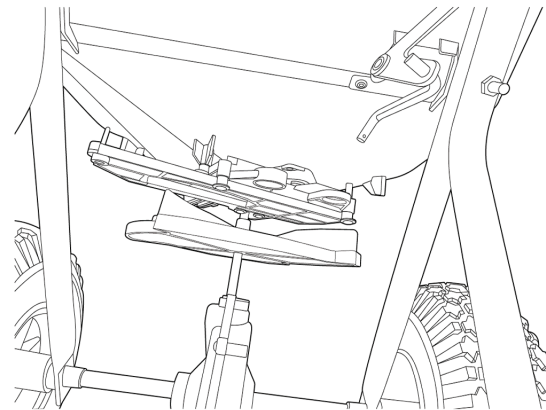
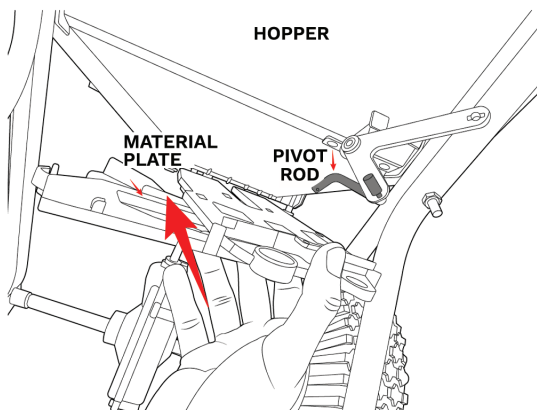

6

Pull the material plate out slightly to allow space to insert the pivot rod (16) back into the pivot bracket (21) and material plate. Once in place, secure it with the cotter pin (24) as shown.

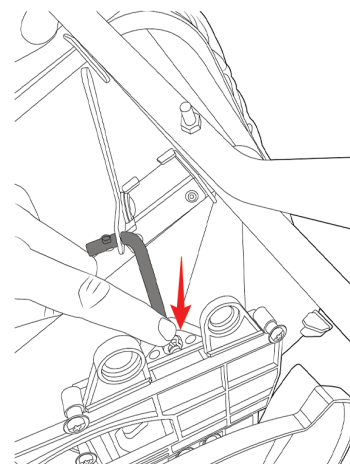
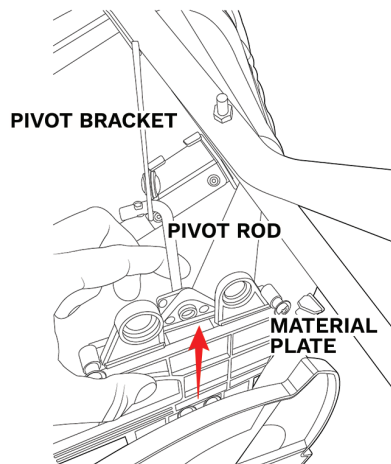

Replacement Parts

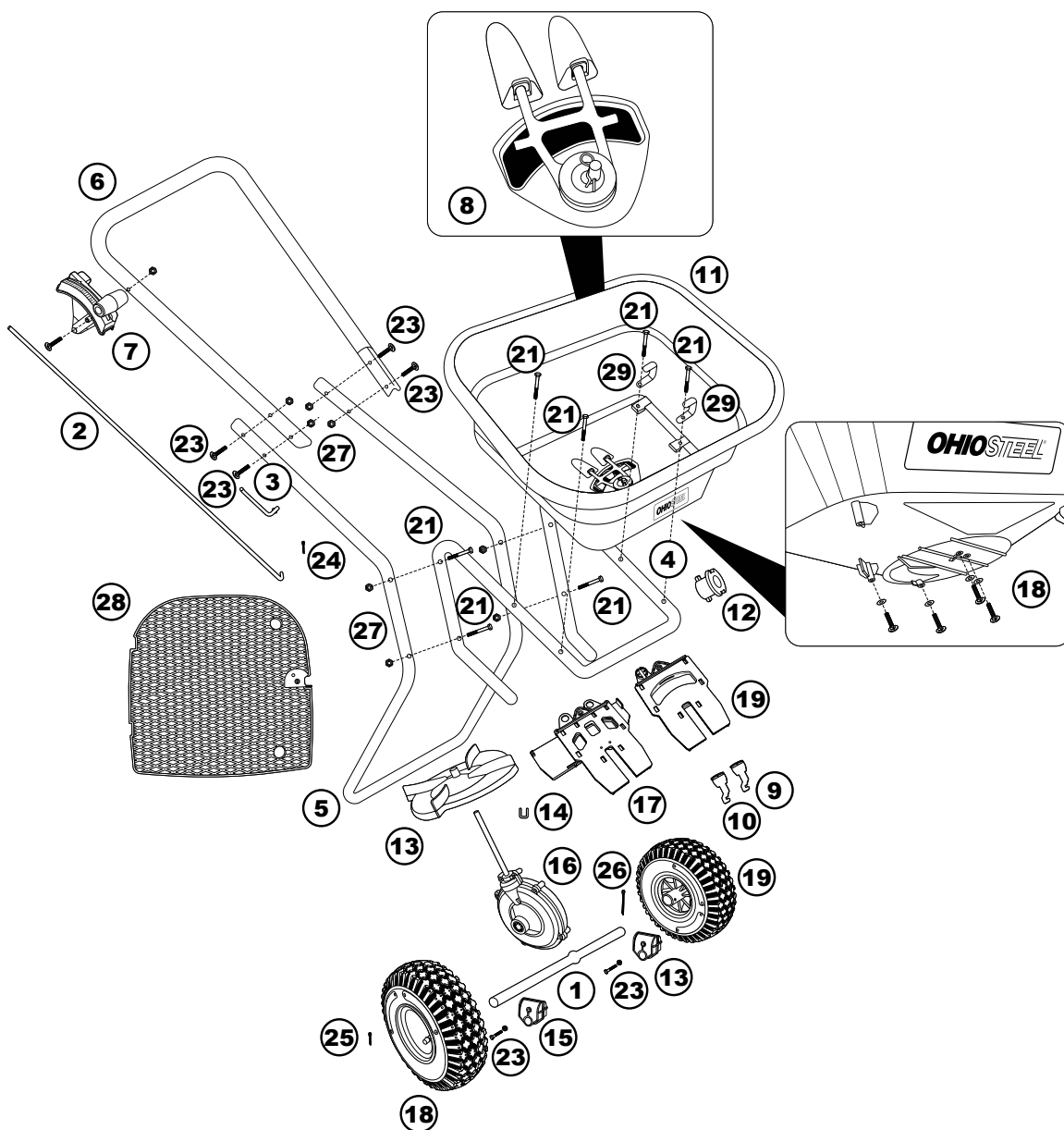

NO.	PART NO.	DESCRIPTION	QTY.	NO.	PART NO.	DESCRIPTION	QTY.
1	6005891	AXLE, TUBE, SPREADER	1	16	6005906	ASSEMBLY, GEARBOX, SPR	1
2	6005892	ROD, UPPER, SPREADER	1	17	6005907	PLATE, MATERIAL, SUMMER	1
3	6005893	ROD, LOWER, SPREADER	1	18	6005908	SCREW, SELF TAPPING, M4.5 X18	4
4	6005894	SUPPORT, HOPPER, SPREADER	1	19	6005909	PLATE, MATERIAL, WINTER	1
5	6005895	FRAME, BACK, SPREADER	1	20	6005910	WHEEL, 13 X 5.0-6 X 16.5MM	2
6	6005896	HANDLE, FORMED, SPREADER	1	21	6005911	BOLT, HEX, M6 X 60	4
7	6005897	ASSEMBLY, CONTROL, SPREADER	1	22	6005912	BOLT, HEX, M6 X 65	4
8	6005898	ASSEMBLY, AGITATOR, 10PPS100	1	23	6005913	BOLT, HEX, M6 X 45	6
9	6005899	BRACKET, AGITATOR, LEFT	1	24	6005914	PIN, COTTER, 1MM X 10MM	1
10	6005900	BRACKET, AGITATOR, RIGHT	1	25	6005915	PIN, COTTER, 3.5MM X 23MM	1
11	6005901	HOPPER, OHIO STEEL, 10 GAL	1	26	6005916	PIN, COTTER, 3.5MM X 45MM	1
12	6005902	BUSHING, HOPPER, SPREADER	1	27	6005917	NUT, HEX LOCK, M6	14
13	6005903	IMPELLER, PLASTIC, SPREADER	1	28	6005918	SIEVE, HOPPER, SPREADER	1
14	6005904	KEY, U SHAFT, SPREADER	1	29	6005919	BRACKET, SIEVE, SPREADER	1
15	6005905	BEARING, AXLE, SPREADER	1				

Notes

OHIOSTEEL[®]



7 16504 18010 9

MODEL #10PPS100

PRODUCT MADE IN INDIA

